

705123  
R

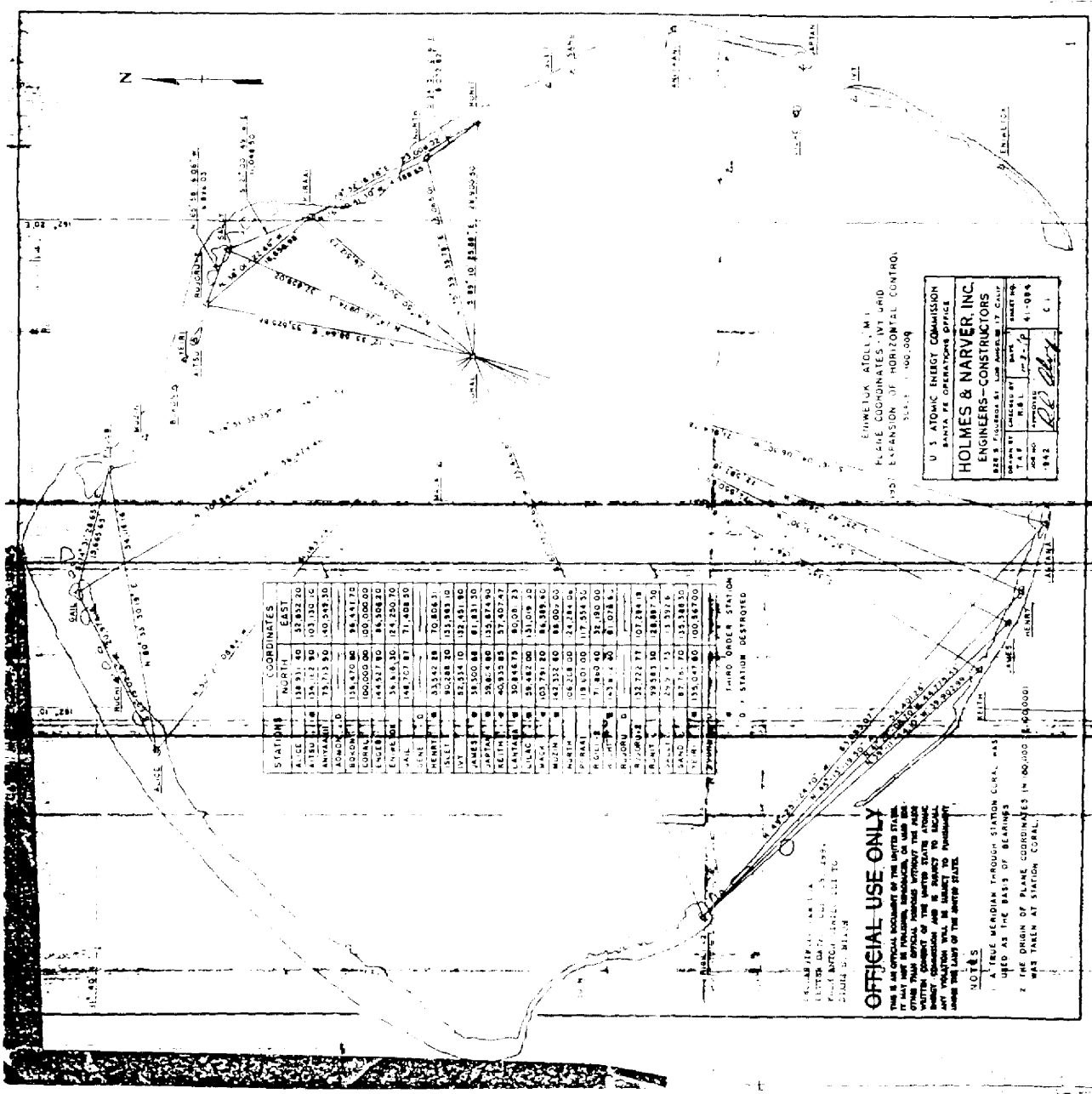

STATIONS	COORDINATES	
	NORTH	EAST
ALICE	187,711.00	57,832.70
ALVIN	138,711.00	103,132.10
ANTHONY	138,711.00	150,032.10
BOONVILLE	118,870.00	98,847.70
CONANT	100,000.00	100,000.00
ENFIELD	144,327.00	86,508.20
FAIR	148,707.81	71,408.10
HEARTY	133,542.88	70,808.31
LEWIS	80,288.10	132,883.10
LYN	12,554.10	132,451.80
AMES	18,500.88	81,831.30
APPLE	28,644.80	135,874.90
BEHNS	40,835.85	57,807.47
LANHAM	30,848.75	80,081.23
LULAC	28,482.00	131,019.20
WALKER	103,791.20	86,389.40
WILSON	142,332.00	88,007.00
WORTH	108,214.00	24,284.00
WYATT	18,803.00	117,534.30
WYATT	15,311.00	81,018.10
WYATT	13,722.71	107,284.18
WYATT	19,383.30	128,887.30
WYATT	25,244.33	13,324.80
WYATT	87,761.70	135,348.10
WYATT	135,041.80	100,857.00

**OFFICIAL USE ONLY**  
 THIS IS A TRUE MENDIAN THROUGH STATION CORRELATION...  
 IT HAS BEEN IN COMPLIANCE WITH THE...  
 OTHER THAN OFFICIAL PURPOSES WITHOUT THE...  
 WRITTEN CONSENT OF THE UNITED STATES ATOMIC...  
 ENERGY COMMISSION AND THE UNITED STATES...  
 ANY VIOLATION WILL BE SUBJECT TO PENALTY...  
 UNDER THE LAWS OF THE UNITED STATES.

**NOTES**  
 1. A TRUE MENDIAN THROUGH STATION CORRELATION...  
 USED AS THE BASIS OF BEARINGS...  
 2. THE ORIGIN OF PLANE COORDINATES IN 100,000...  
 WAS TAKEN AT STATION CORRELATION...

U.S. ATOMIC ENERGY COMMISSION  
 SANTA FE OPERATIONS OFFICE  
**HOLMES & NARVER, INC.**  
 ENGINEERS-CONSTRUCTORS  
 808 S. WASHINGTON ST., LOS ANGELES 17, CALIF.  
 DRAWN BY: [Signature] DATE: 1-2-59  
 CHECKED BY: [Signature] DATE: 1-2-59  
 APPROVED BY: [Signature] DATE: 1-2-59

ENVELOPE 400 (L.M.)  
 PLEASE COORDINATES INT. AND  
 100% EXPANSION OF HORIZONTAL CONTROL.  
 1:50,000

STATION...  
 COORDINATE...  
 BEARING...  
 DISTANCE...