

8-PROGRAM

Effects on Aircraft



Radar Scope Photography
Yield-Bombing accuracy,
height of burst-damage.

Aerial Photography
Before Bomb Damage
During Assessment
After

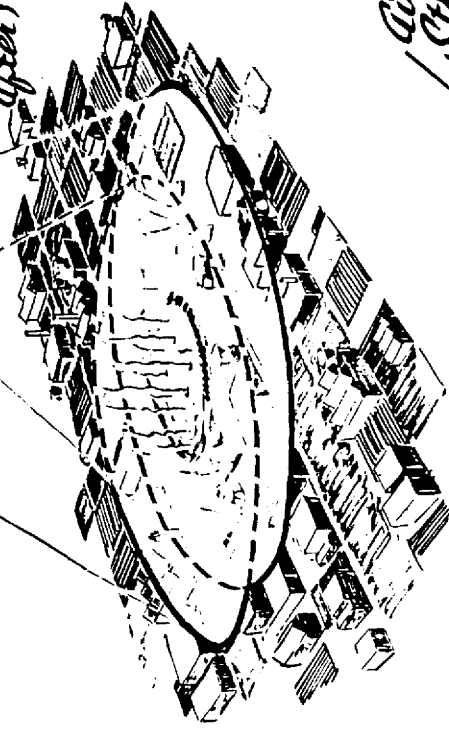

Aircraft
Stress Tests

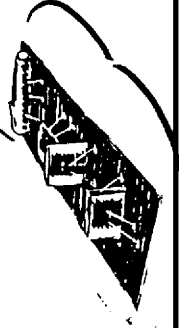

Radio Propagation
Tests



7-PROGRAM

Long Range Detection

Cloud Sampling 4%

Acoustic
Recording Sta.

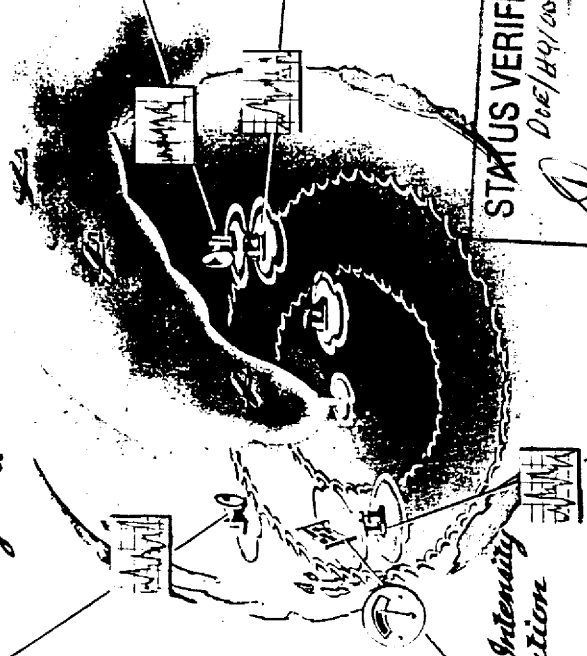

Acoustic
Recording
Station

Seismograph
Station

STATUS VERIFIED UNCLASSIFIED
Doe/84/00 PPT 144- 11/97

AUTHORIZED DERIVATIVE
CLASSIFIER Declassify

Seismograph
Station

Light Intensity
Station

STATISTICAL SERVICE
RESEARCH (R-1)

E. LOCKE

5-Program Evaluation of Radiac Equipment

TEST - Personnel Dosimeter
for measuring radiation dose

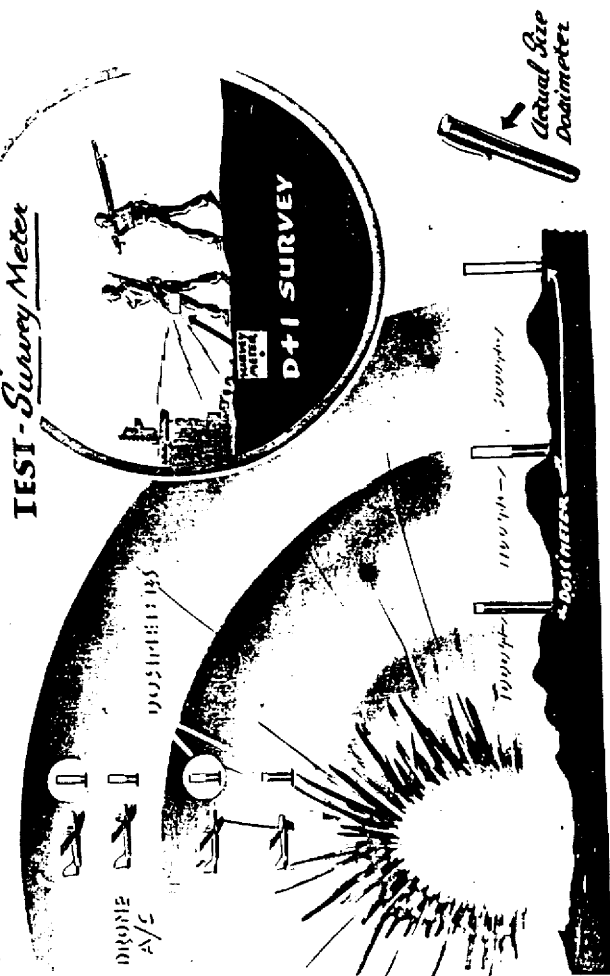

IESI - Radiological Laboratory

Field Lab. (Mobile)
Radio-Physical Chemical Analysis

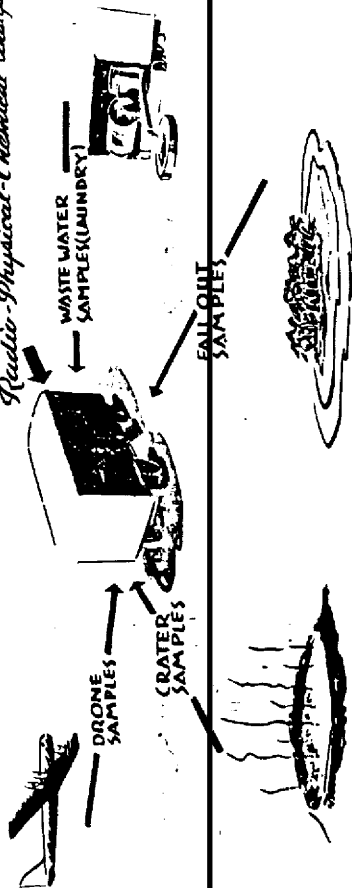

LOCKE
STATISTICAL SERVICE
FORM 10-1

6-PROGRAM

Physical Tests & Measurements

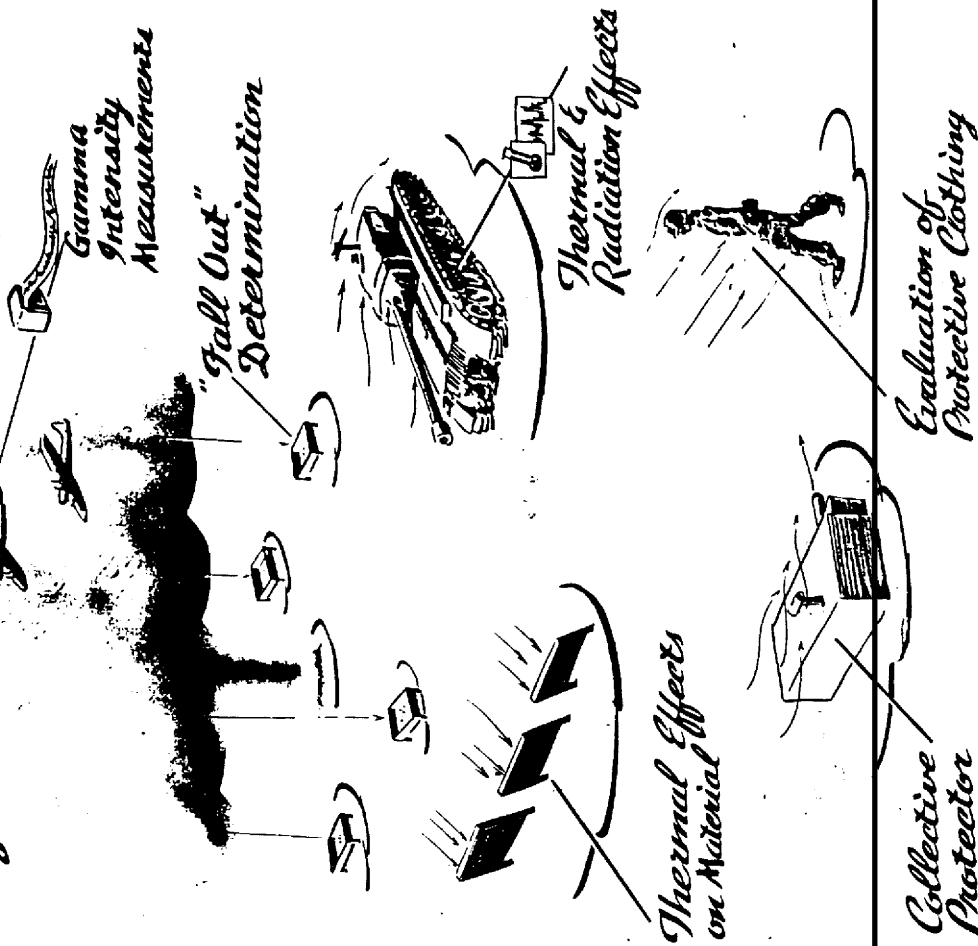

LOCKE
STATISTICAL SERVICE
FORM 10-1

4-PROGRAM Cloud Physics

Measuring
Atmospheric
Conductivity

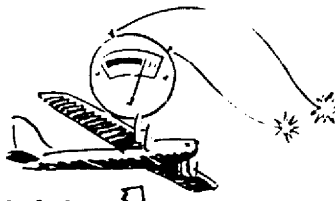

Cloud
Photography

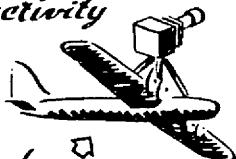

Cloud
Documentation

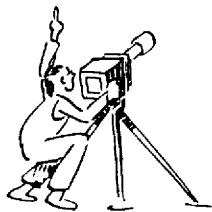

Weather Forecasting
Research

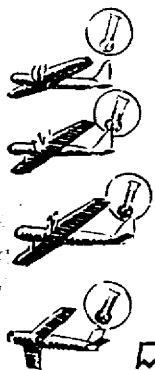
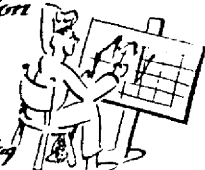

Aerograph Program
Drone 4/c

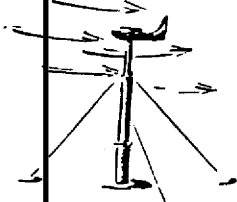

After-Wind
Measurements

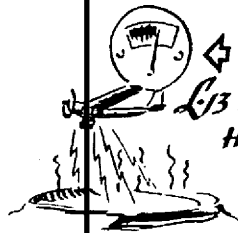

L13 Crater Survey
H+10 hrs

Industrial Building "Long Span"

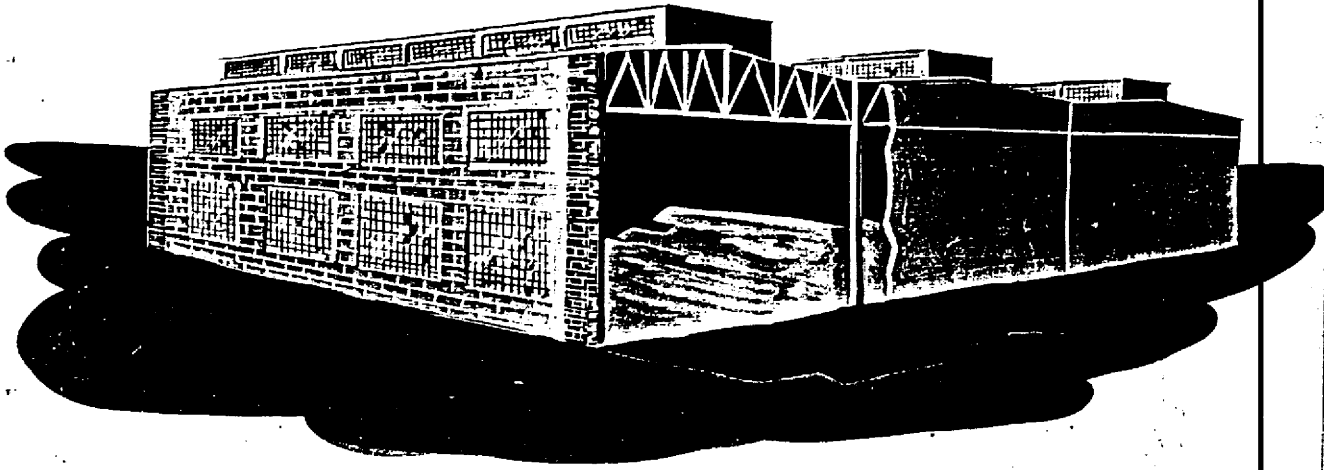

Test Structure 3.2.7a

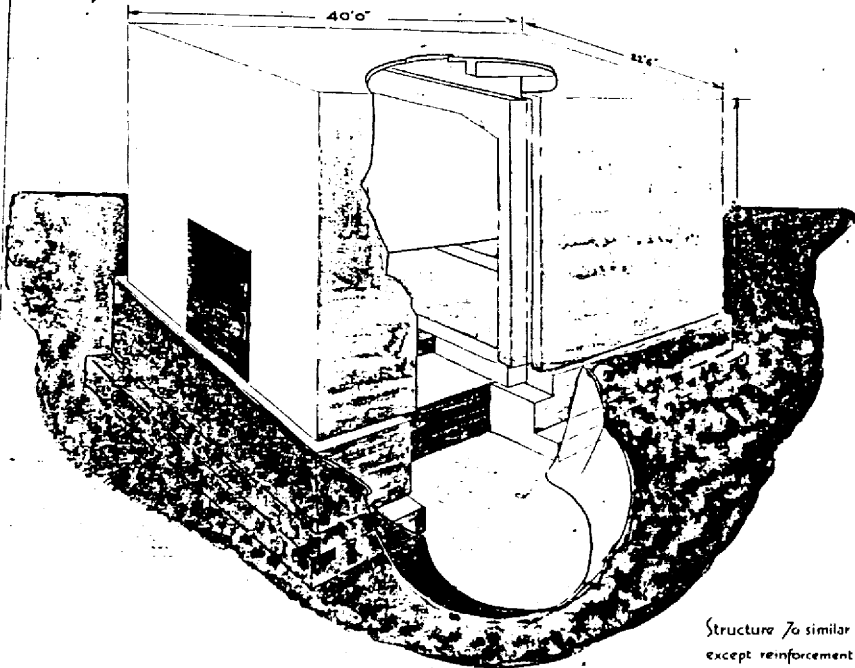

Structure 7a similar to 7b -
except reinforcement is doubled.

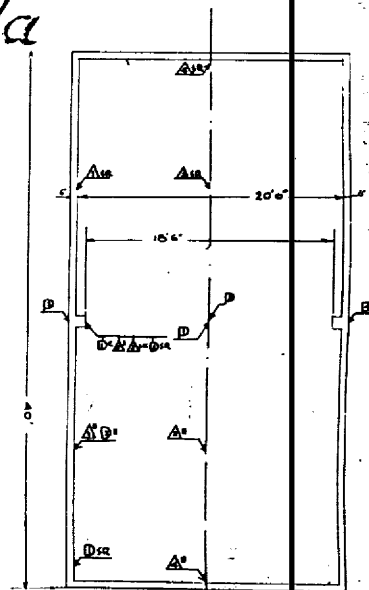

INSTRUMENTATION 7a-7b

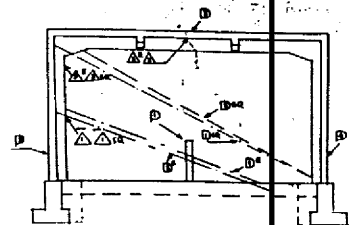

Load bearing wall dwelling time

Load bearing wall dwelling type

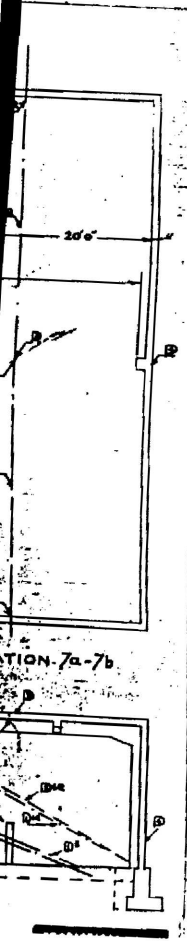
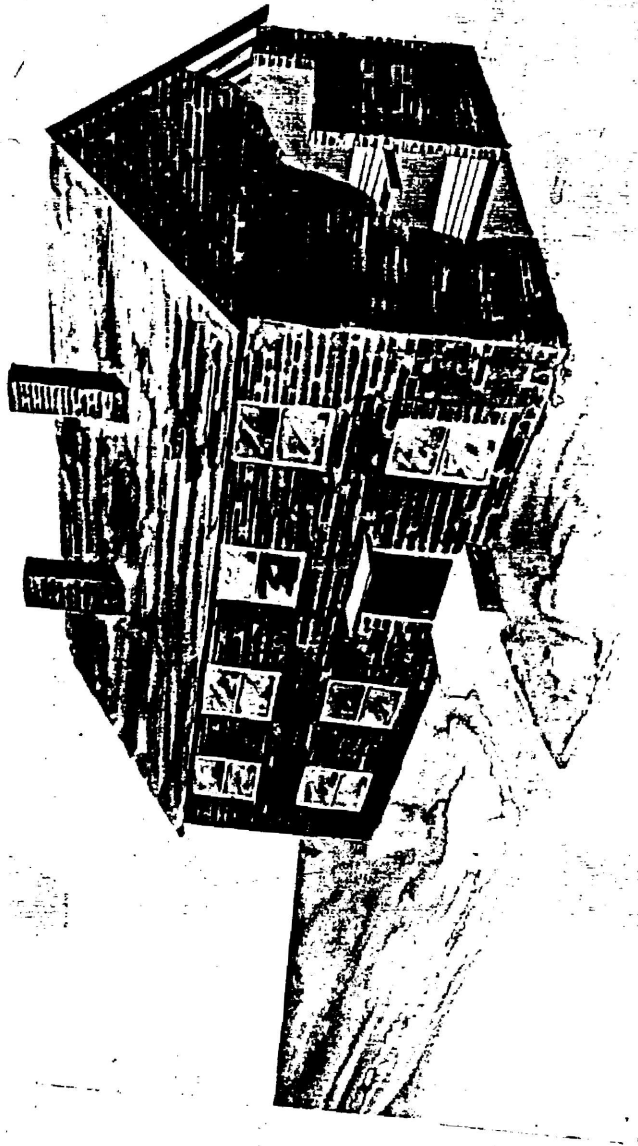

Test Structure 3.2.1a

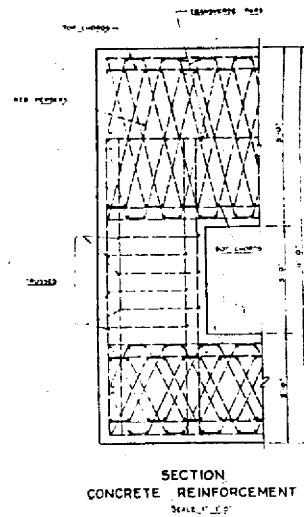
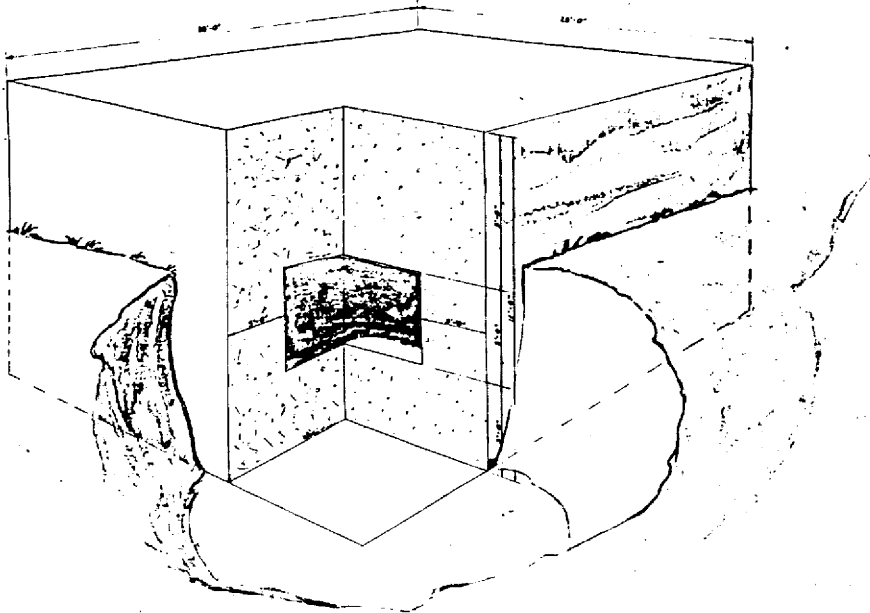

Test Structure 3.2.2b

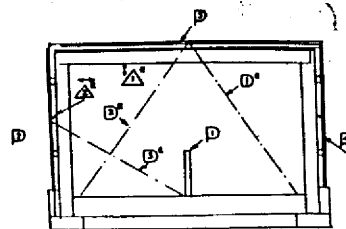
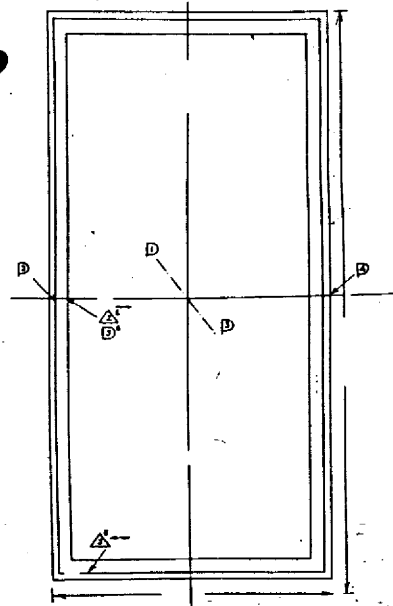
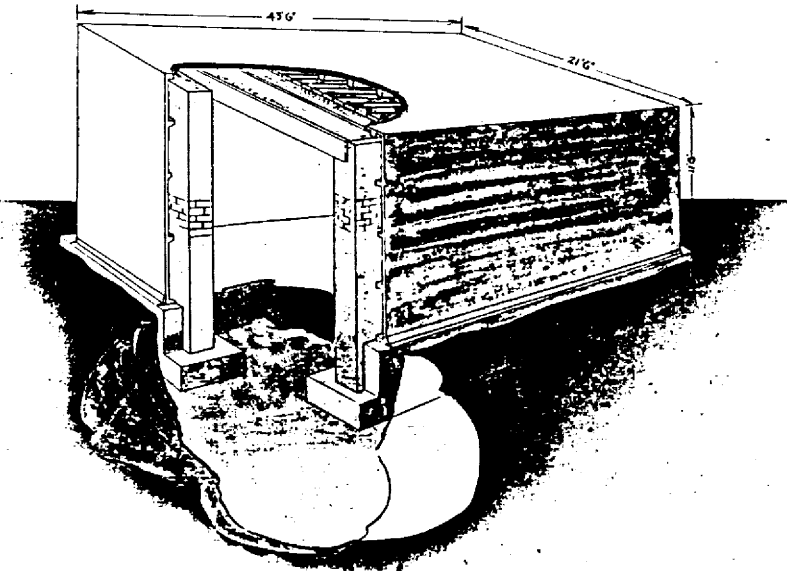

Test Structure 3.2.4a

a

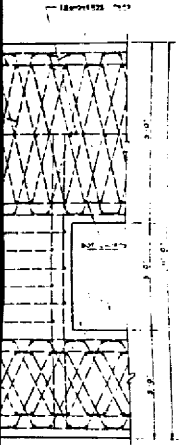

SECTION
STEEL REINFORCEMENT
SCALE: 1/4" = 1'-0"

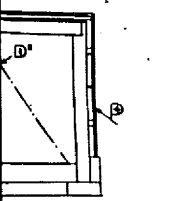
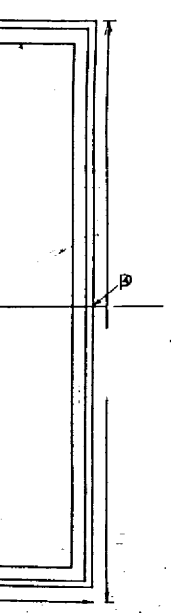

Test Structure 3.2.4a

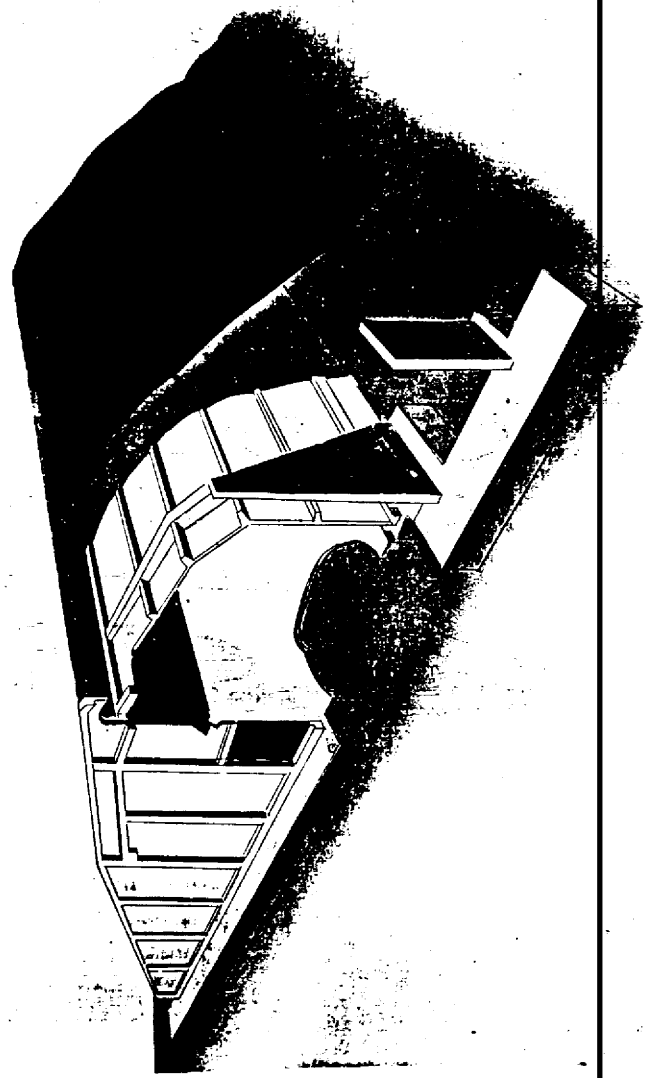

3-PROGRAM Structures

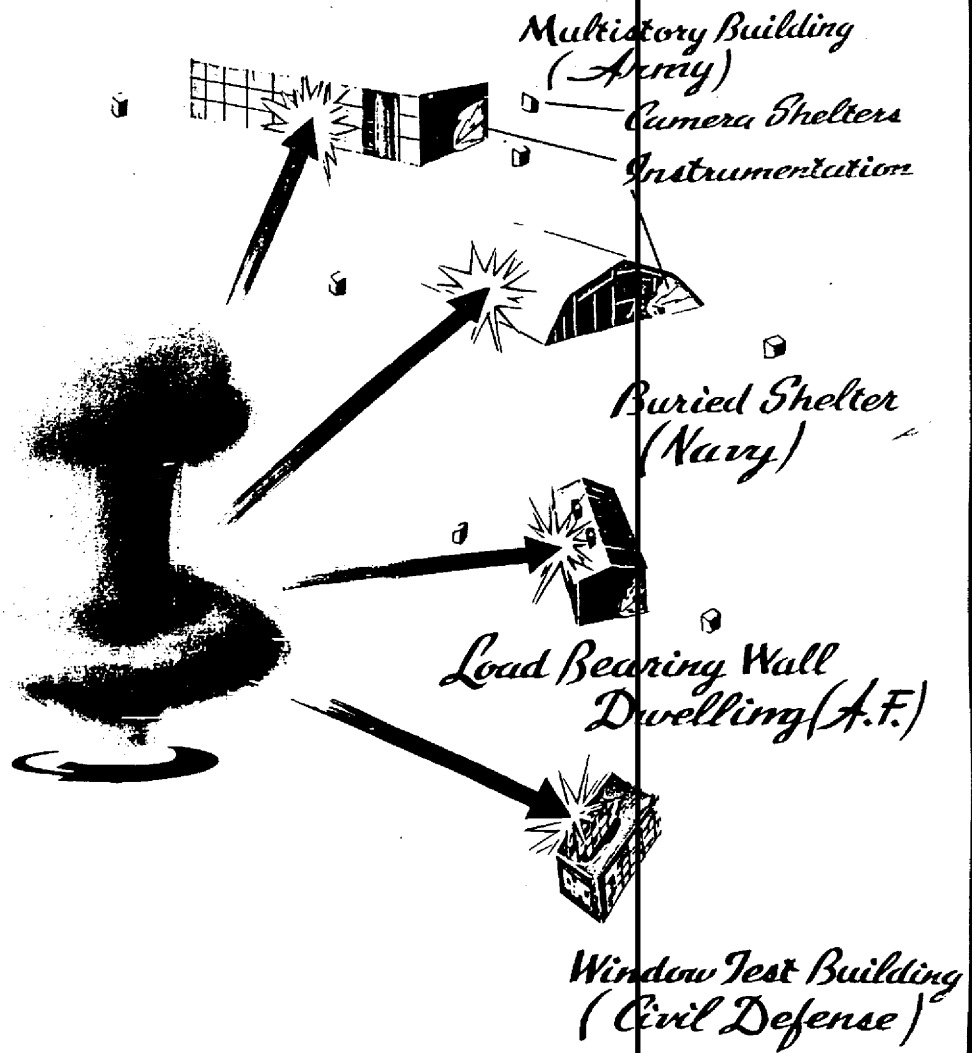

E. LOCKE

STATISTICAL SERVICES

12/10/1964

2-PROGRAM

Bio-Medical

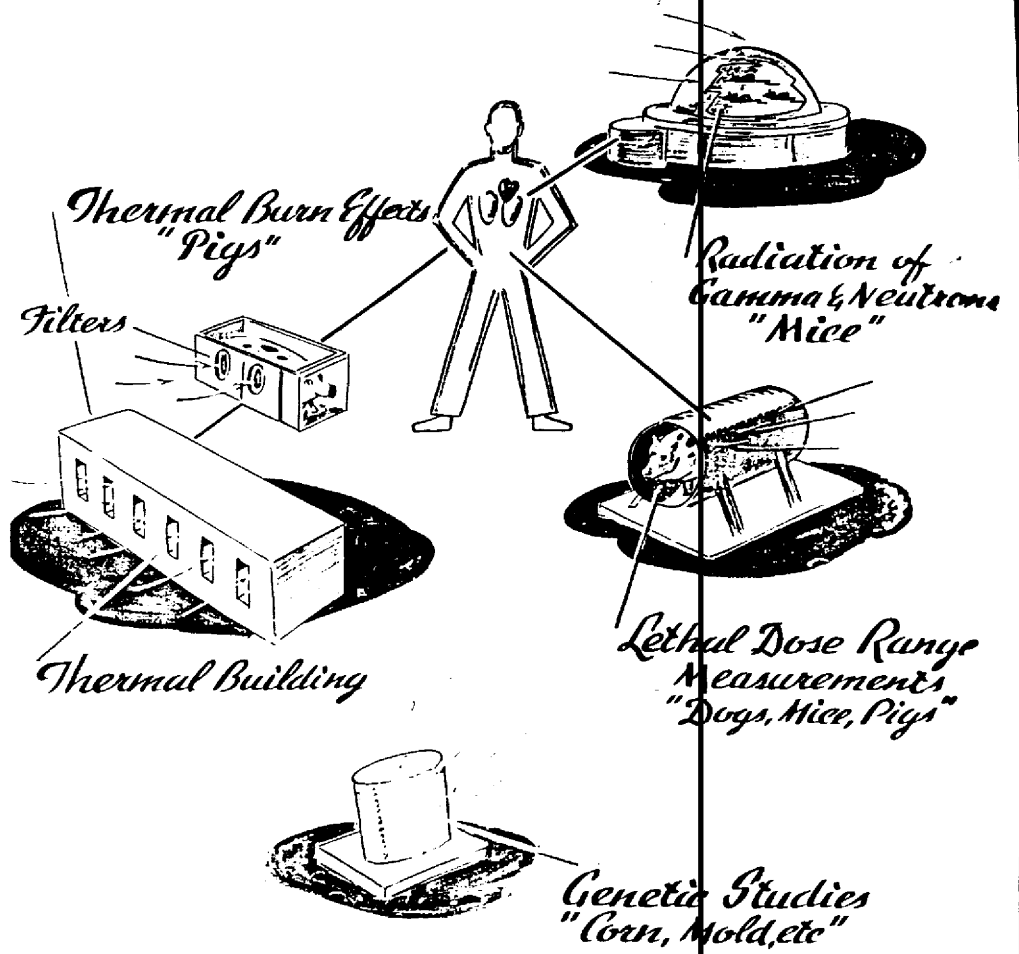

Screening and Integration of Experimental Projects

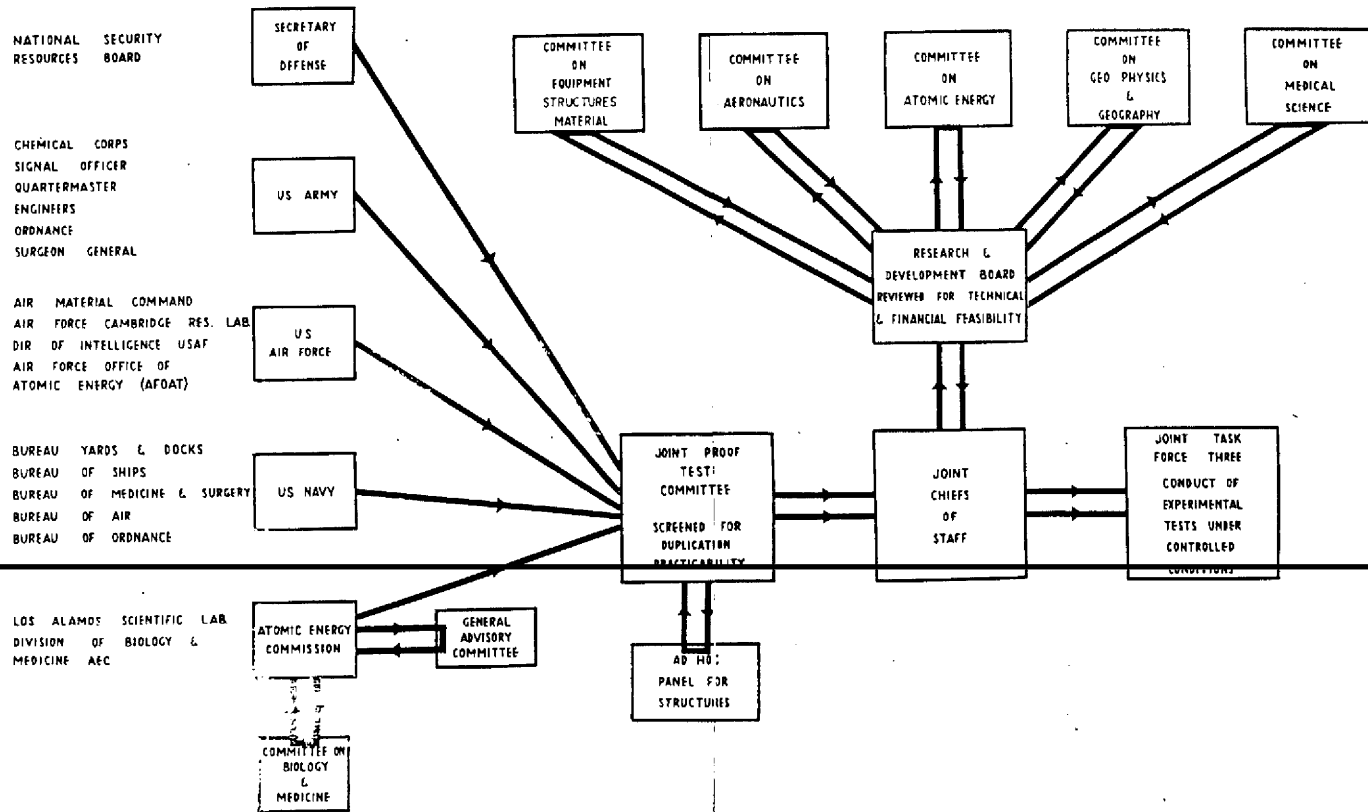

SECRET

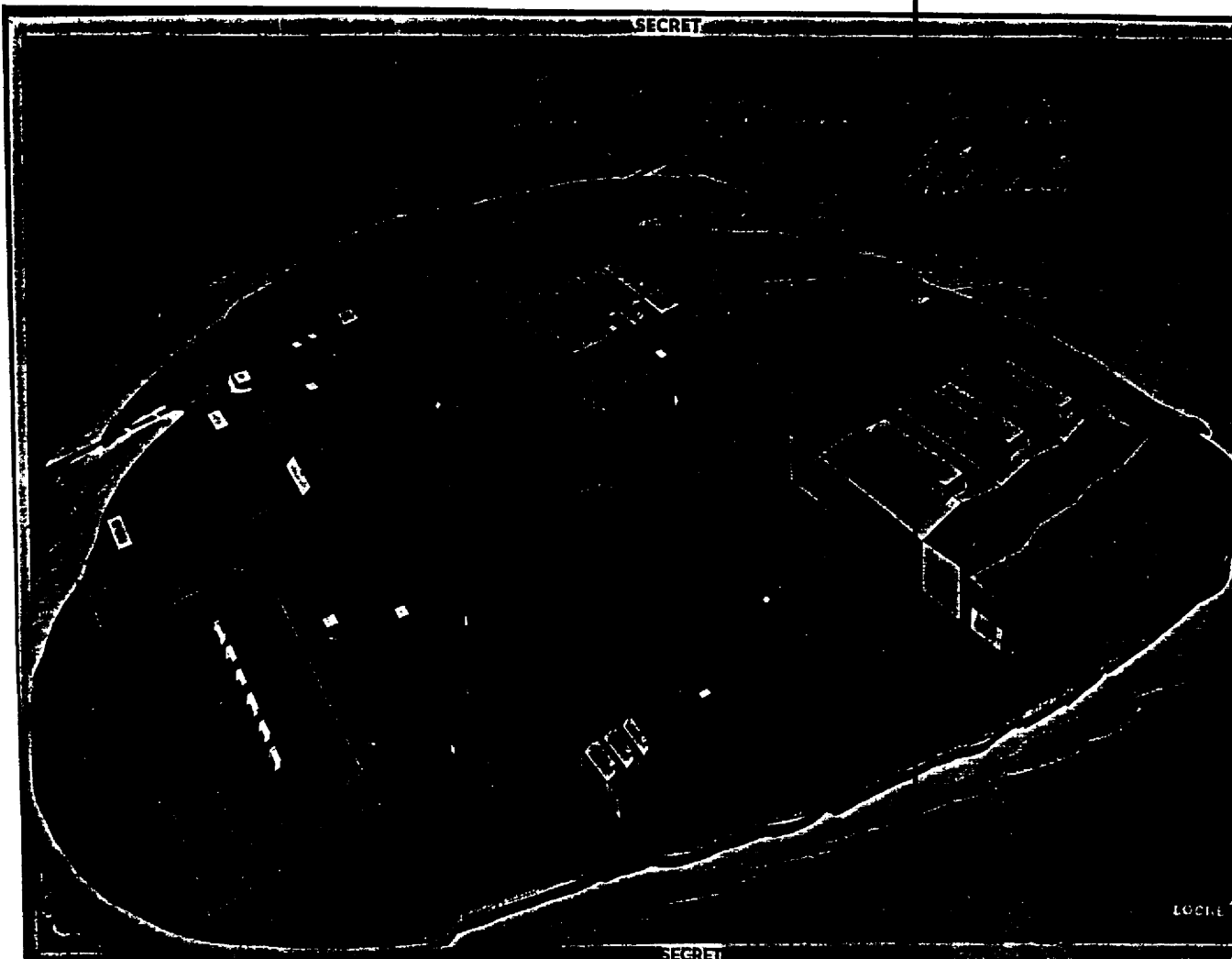

LOC 1

SECRET

SECRET

*"Dog Shot" Instrumentation
Ergebi*

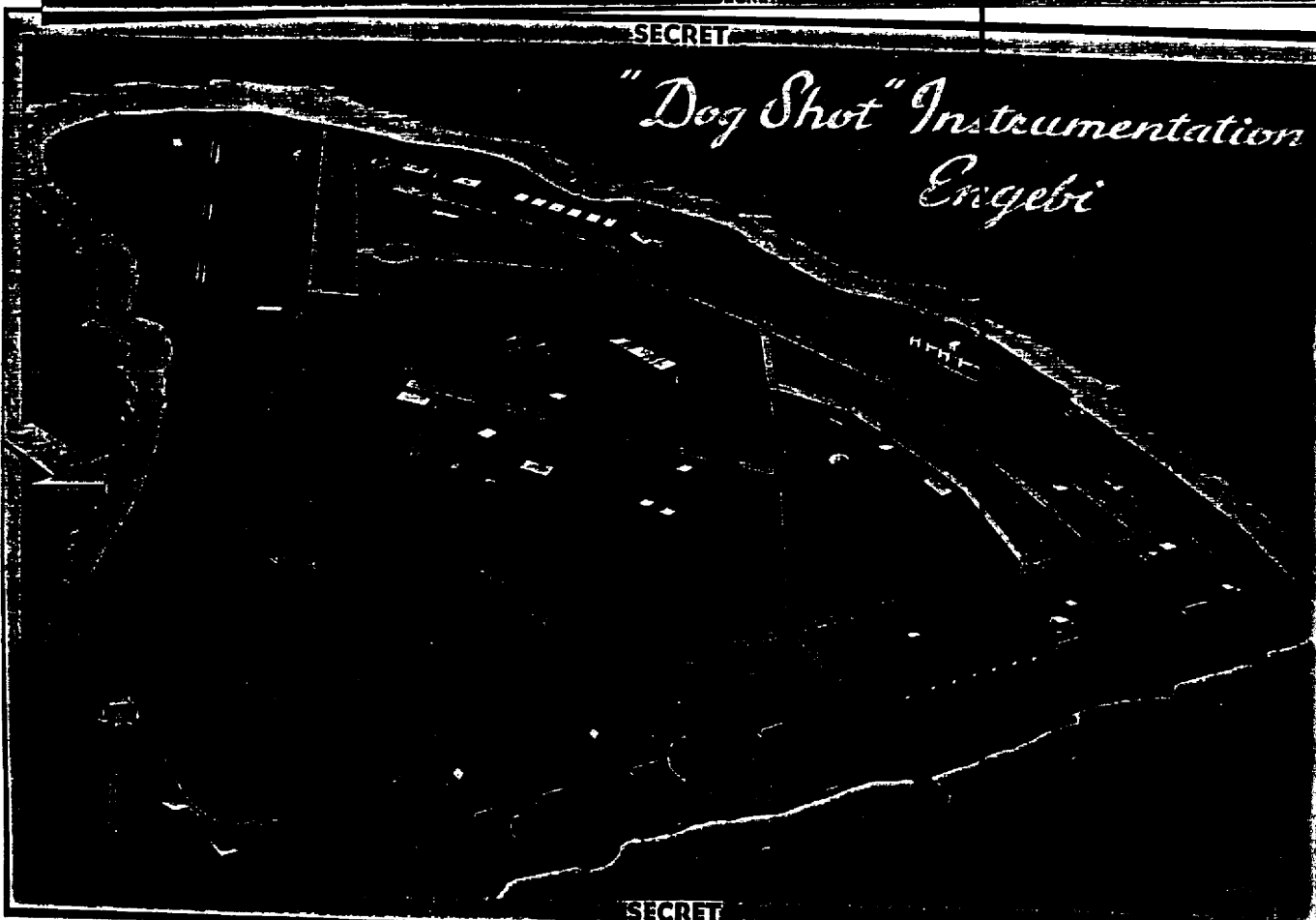

SECRET

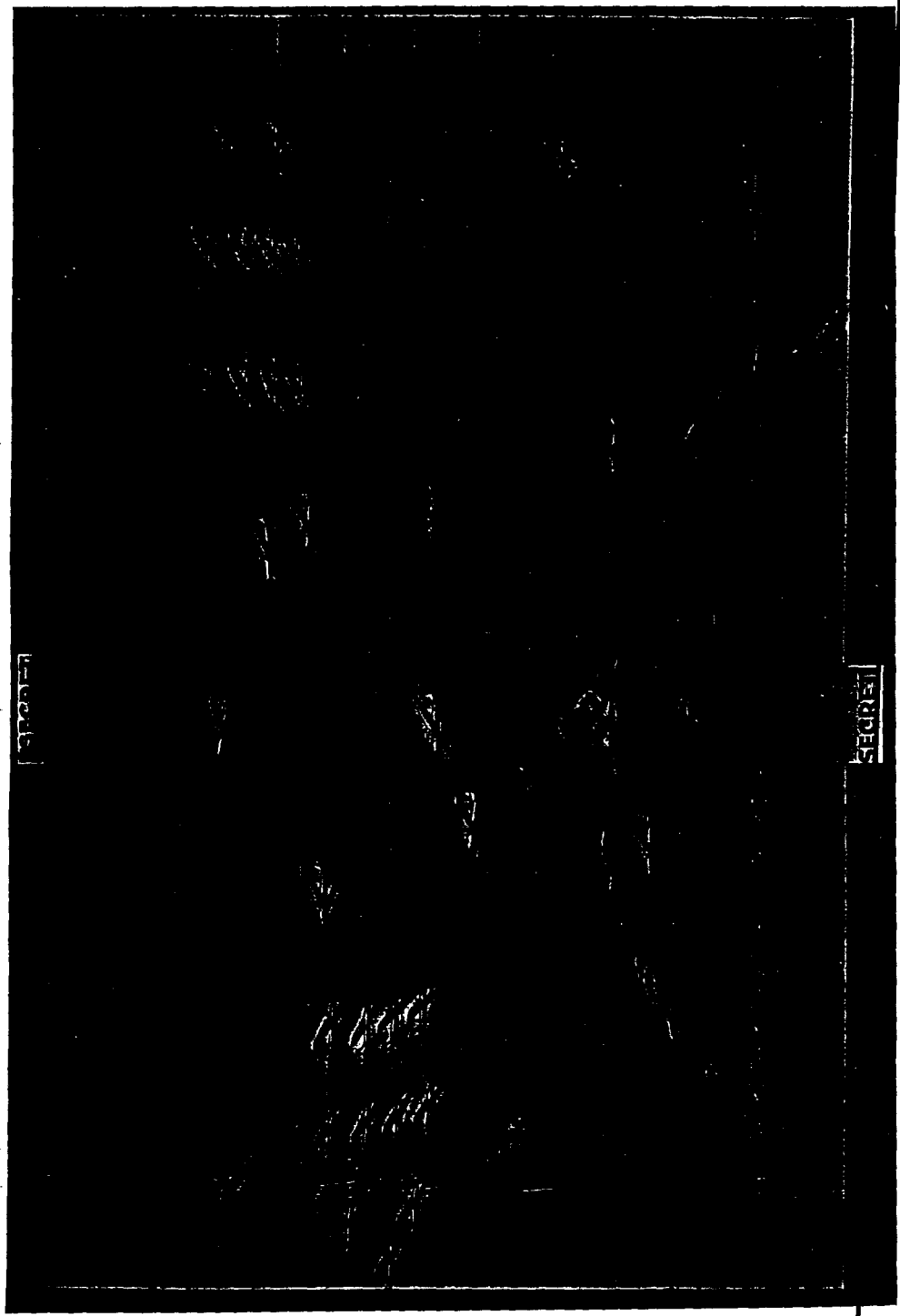
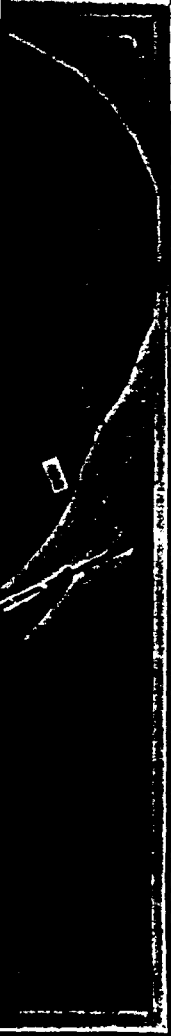

SECRET

SECRET

Special Operations Equipment

POWER SUPPLY

SNAP SAMPLER

ELECTRO-STATIC PRECIPITATOR

THERMAL PRECIPITATOR

BIOLOGICAL SAMPLER



RADAC CONTROL
 RADAC SUPPLY
 POWER SUPPLY
 RADAC RECORDER
 RADAC INDICATOR
 POWER UNIT
 RECORDER

AIR FILTERS

POWER SUPPLY
 SNAP SAMPLER
 ELECTRO-STATIC PRECIPITATOR
 THERMAL PRECIPITATOR

SECRET

Blast and Pressure Instrumentation

SECRET

STRAIN GAGE
 STRAIN GAGE CONTROL BOX
 THERMISTOR
 MICROPHONE
 ACCELEROMETER
 STRAIN GAGE

STRAIN GAGE

STRAIN GAGE

STRAIN GAGE
 STRAIN GAGE
 STRAIN GAGE

PRESSURE PICK-UP

STRAIN GAGE

PRESSURE PICK-UP
 STRAIN GAGE
 CONTROL BOX
 THERMISTOR
 MICROPHONE
 ACCELEROMETER
 STRAIN GAGE

ELEVATOR POSITION INDICATOR

STRAIN GAGE

STRAIN GAGE

STRAIN GAGE

STRAIN GAGE

STRAIN GAGE

STRAIN GAGE

STRAIN GAGE

SECRET

SECTION IV

ILLUSTRATIONS

~~RESTRICTED~~

NATIVE POPULATION

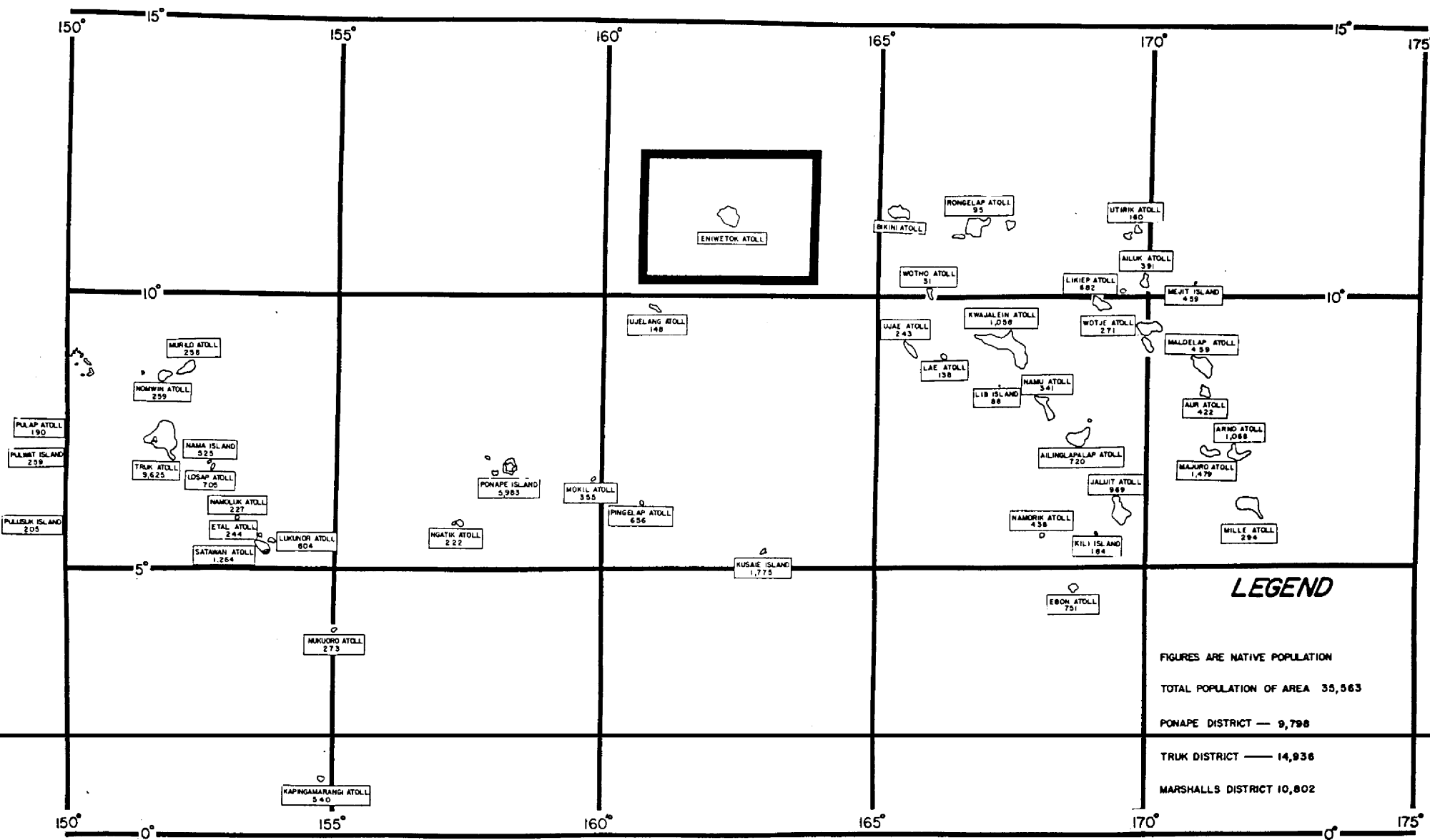

DECLASSIFIED

E.O. 10501, NOV. 6, 1953

NLE BY _____ DATE _____

~~RESTRICTED~~

STATISTICAL

SOVIET RECONNAISSANCE CAPABILITY AGAINST ENIWETOK

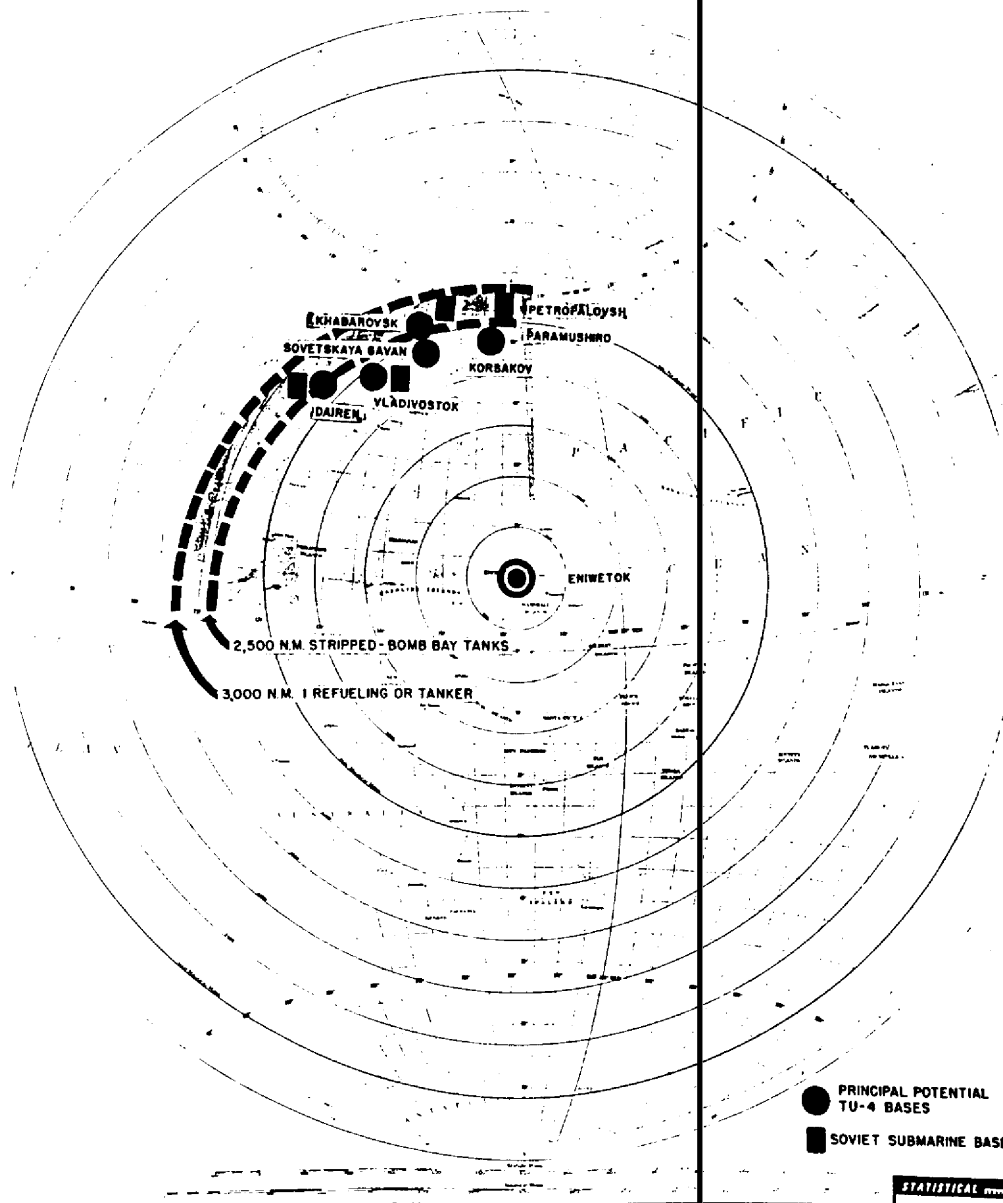

SECRET

STATISTICAL (SECRET)
SECURITY P. 3

Water Shipment

San Francisco To Eniwetok



Kauai
Eniwetok



Lifted thru March '51 ~~132,535~~ 139,446 TONS
 139,446 ships
 Estimated thru July '51 ~~207,400~~ 209,736 TONS
 156 ships
 162

Airlift



Kauai
Eniwetok



Lifted thru March '51 ~~1848~~ 25531 TONS
 Estimated thru July '51 32488 TONS

SECRET

Projected Overall Strength

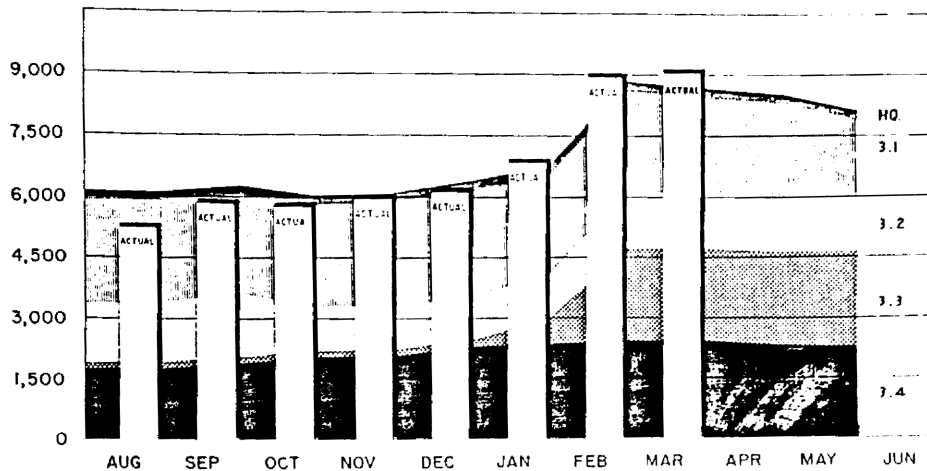

TOTAL	JTF-3 PRO. ST.	6184	6314	6065	6214	6502	6849	8868	8740	8542	8144	4650
HQ JTF-3	200	200	200	200	200	200	200	200	200	200	200	165
TG 3.1	2504	2431	2514	2600	2655	2498	2474	2346	2201	1821	1421	1485
TG 3.2	1561	1632	1157	1156	1156	1156	1389	1389	1405	1421	850	
TG 3.3	192	192	192	192	192	621	2373	2373	2373	2373	2373	1878
TG 3.4	1727	1859	2002	2066	2299	2374	2432	2432	2363	2330	272	
TOTAL JTF-3 ACTUAL ST.	5274	5830	5782	6106	6463	7018	9059	9104	8751	7163		
HQ JTF-3	173	178	177	186	184	191	172	185	190	190		
TG 3.1	1835	2314	2444	2530	2616	2890	2687	2533	2309	1785		
TG 3.2	1396	1438	1157	1227	1234	1261	1400	1399	1387	1420		
TG 3.3	143	119	146	172	176	285	2374	2585	2521	2408		
TG 3.4	1727	1781	1858	1991	2253	2391	2426	2402	2344	2360		

Projected Strength by Location

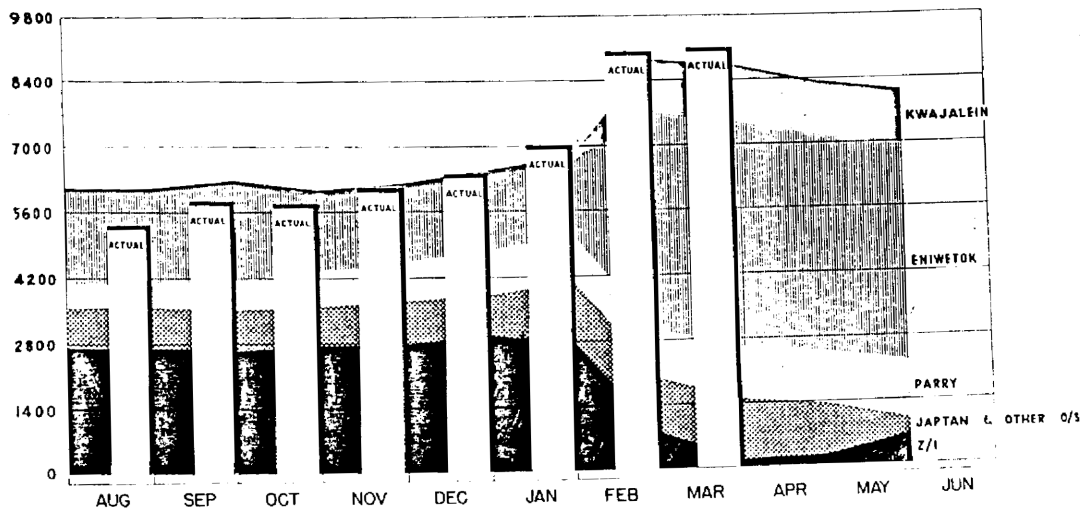

TOTAL PROJECTED STR.	6184	6314	6065	6214	6502	6849	8868	8740	8542	8144	4650
KWAJALEIN	96	96	110	110	103	182	1179	1253	1201	1181	64
ENIWETOK	1988	2059	1602	1590	1603	1571	4674	4843	4835	4707	1507
PARRY	500	641	753	827	987	981	1033	1128	1148	1232	460
JAPAN & OTHERS O/S	882	882	856	934	885	1383	1183	1329	1134	355	179
Z/I	2718	2636	2744	2753	2924	2732	799	187	224	669	2440
TOTAL ACTUAL STR.	5312	5830	5782	6106	6463	7018	9059	9104	8751	7163	
KWAJALEIN	100	100	115	110	113	139	1169	1135	1125	907	
ENIWETOK	1790	1850	1639	1680	1666	1808	4701	5065	5121	4019	
PARRY	640	752	740	761	890	962	1229	1279	1373	1322	
JAPAN & OTHERS O/S	665	794	886	942	1048	1179	1250	1436	962	135	
Z/I	2117	2334	2402	2613	2746	2930	710	189	170	780	

- EMPLOYMENT OF ATG-3.4 AIRCRAFT BY PROJECT -

PROJECT NUMBER	AGENCY	PROJECT DIRECTOR	PROJECT NAME	NUMBER & TYPE AIRCRAFT INVOLVED	NO OF FLIGHTS PER SHOT	OTHER PROGRAMS USING SAME A/C	CU CONTROLLING AIRCRAFT
1.4	EG B G	DR. H. GRIER	VISIBLE RAD. MEASUREMENTS	1 HELICOPTER	(AFTER SHOT TIME)	3.0	3.4.6
1.5.1	LASL	DR. W. OGLE DR. L. ROSEN	NEUTRON MEASUREMENT	1 HELICOPTER	(AFTER SHOT TIME)	3.0	3.4.6
1.7	LASL	DR. R. SPENCE	RADIO TECHNICAL DETERMINATION	8 QB-17 12 DB-17	1 1	10, 4.0, 5.0 8.0, 7.0	3.4.2
2.5.4	LASL	DR. R. CARTER	DISTRIBUTION OF FISSION PRODUCTS	3 AEC QB-17	1	10, 4.0, 3.0, 8.0, 7.0	3.4.2
2.5.5.1	ORNL	DR. A. CONGER	BIOLOGICAL DOSIMETRY (TRADESCANTIA)	8 AEC QB-17 12 AEC DB-17	1 1	10, 4.0, 3.0 8.0, 7.0	3.4.2
2.5.5.4	LASL GAMMA RAYS	DR. R. CARTER	BIOLOGICAL DOSIMETRY (MICE)	3 AEC QB-17	1	10, 4.0, 3.0, 8.0, 7.0	3.4.2
3.0 PROGRAM	LASL-AMC-BUVD OGE-SANDIA	LCDR. W. ROWEN	STRUCTURES	1 HELICOPTER	(AFTER SHOT TIME ONLY)	1.0	3.4.6
4.1	AFCLL	MR. C. ANDERSON MR. A. MIRARCHI	CLOUD PHYSICS	2 B-50D 8 AEC QB-17 12 AEC DB-17 2 EOT-33 3 EOT-33	1 1 1 1 1	10, 3.0, 3.0 8.0, 7.0, 8.0	3.4.2
4.6	AFCLL	MR. CORONITI	ATMOSPHERIC CONDUCTIVITY	2 B-50A 1 L-13	1 1	7.0	3.4.2 3.4.6
5.1	DSCO	MR. C. T. CLAYTON	RADIOLOGICAL DETECTION SERVICE TEST	8 AEC QB-17 12 AEC DB-17	1 1	10, 2.0, 4.0 8.0, 7.0	3.4.2
5.2	USN BUAER	LCDR. J. A. TERRY	AIRBORNE RADIOLOGICAL EQUIPMENT	1 P2-V-2 1 B-17	1 1	FLIGHT PER DAY FROM 5 DAYS OR 8 DAYS EACH SHOT FLIGHT PER DAY FROM 3 DAYS OR 8 DAYS EACH SHOT	3.4.2
6.1	ACC	MR. J. P. MITCHELL	CLOUD PARTICLE SIZE AND DISTRIBUTION	8 AEC QB-17 12 AEC DB-17	1 1	10, 2.0, 4.0 8.0, 7.0	3.4.2
6.5	NRDL	DR. P. C. TOMPKINS	SURVEY METER INTERPRETATION	8 AEC QB-17 12 AEC DB-17	1 1	11, 2.0, 4.0 8.0, 7.0	3.4.2
6.6	ACC	MR. E. ENGQUIST	FILTER MATERIAL EVALUATION	8 AEC QB-17 12 AEC DB-17	1 1	10, 2.0, 4.0 8.0, 7.0	3.4.2
6.7	NRDL	DR. L. B. WERNER	ALOFT CONTAMINATION & DECONTAMINATION STUDIES	8 AEC QB-17 12 AEC DB-17	1 1	10, 2.0, 4.0 8.0, 7.0	3.4.2
6.8	NRDL	DR. P. C. TOMPKINS	CLOUD RADIATION FIELD	8 AEC QB-17 12 AEC DB-17	1 1	11, 2.0, 4.0 8.0, 7.0	3.4.2
7.4	AFOAT-1	DR. W. D. URRY	COLLECTION OF BOMB DEBRIS BY AIRBORNE FILTERS	2 B-50A 5 WB-29	1 1	4.0	3.4.2 3.4.4
7.8	AFOAT-1	DR. W. D. URRY	DETECTION OF BOMB DEBRIS BY ATMOSPHERIC CONDUCTIVITY	2 B-50A 5 WB-29 2 B-50D	1 1 1	4.0, 7.0	3.4.2 3.4.4
8.1	AMC	MR. J. WAYNE	AIRBORNE AIRCRAFT	2 B-50D 2 QB-17 USAF 3 DB-17 USAF 2 EOT-33 4 EOT-33 1 B-47	1 1 1 1 1		3.4.2
8.3	AMC	MR. W. R. BOARIS	RADAR SCOPE PHOTOGRAPHY	2 B-50A 3 B-50D 1 B-47	1 1 1	4.0, 7.0	3.4.2

WEATHER STATIONS

SECRET

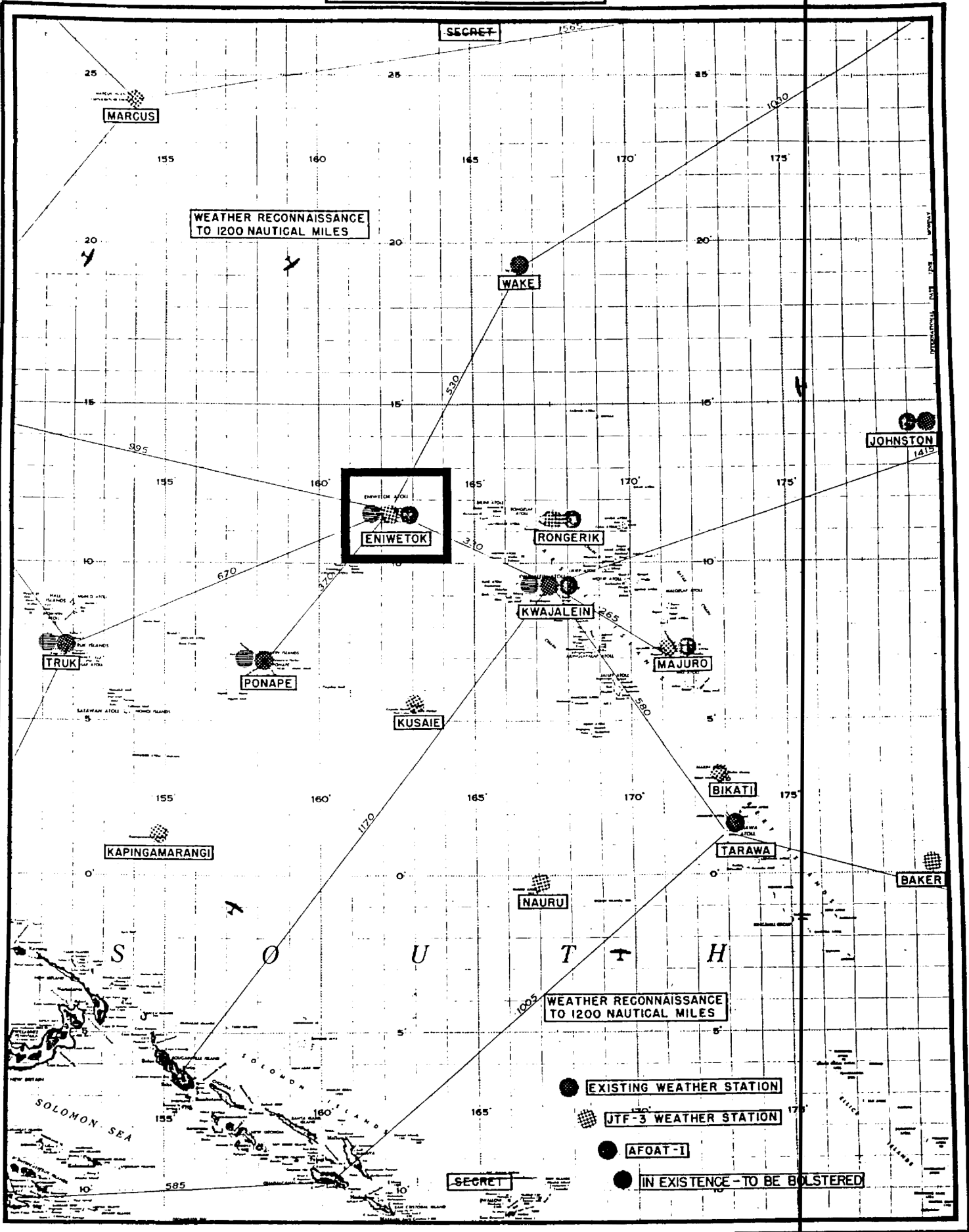

STATISTICS
1957

EXPERIMENTAL PROGRAMS OPERATION GREENHOUSE

PROGRAM NO.	DESCRIPTION	SPONSOR	ACT. COST <small>THRU 31 March</small>
1.0	<u>LOS ALAMOS TESTS</u> WEAPONS PERFORMANCE & INVESTIGATION OF PHENOMENOLOGY	AEC	\$ 37,669,368
2.0	<u>BIO - MEDICAL</u> STUDY OF RADIATION IN BIOMEDIC EFFECTS USING ANIMALS	AEC & DOD	\$ 1,919,996
3.0	<u>STRUCTURES</u> DESIGN CRITERIA & VULNERABILITY OF STRUCTURES IN DEFENSE & OFFENSE	ARMY, NAVY & AF	\$ 4,682,625
4.0	<u>CLOUD PHYSICS</u> CHARACTERISTICS & BEHAVIOR OF ATOMIC CLOUDS	AF	\$ 882,885
5.0	<u>RADIAC EVALUATION</u> EVALUATE RADIATION DETECTION EQUIPMENT	AF & NAVY	\$ 392,206
6.0	<u>PHYSICAL TESTS & MEASUREMENTS</u> CLOUD PARTICLE DISTRIBUTION & SAMPLES THERMAL & CONTAMINATION EFFECTS	ARMY & NAVY	\$ 631,621
7.0	<u>LONG-RANGE DETECTION</u> DETECTION & ANALYSES OF FOREIGN EXPLOSIONS	USAF	\$ 427,036
8.0	<u>EFFECTS ON AIRCRAFT</u> PRESSURE EFFECTS ON AIRCRAFT & INVESTIGATION OF DESIGN CRITERIA	USAF	\$ 14,610,706

SECTION III

OPERATIONS

Cumulative Costs

2nd April 51

PROJECTED
\$110 MILLION
TOTAL TO DATE \$68,813,355

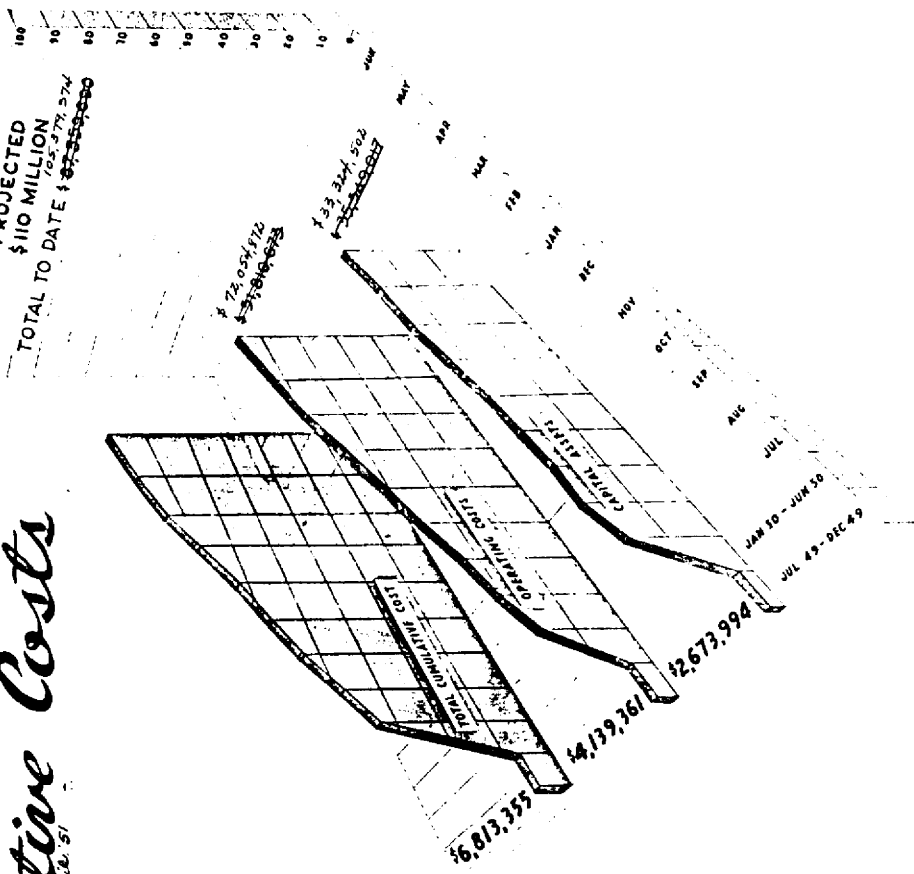

PROJECTIONS

ESTIMATED AND ACTUAL COST

TOTAL ESTIMATE

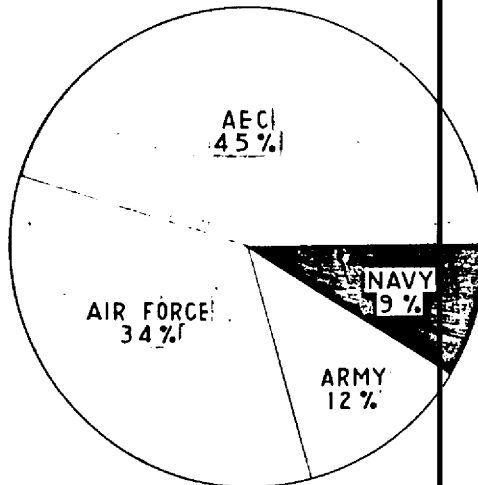

TOTAL \$ 110 M

SUPPORT

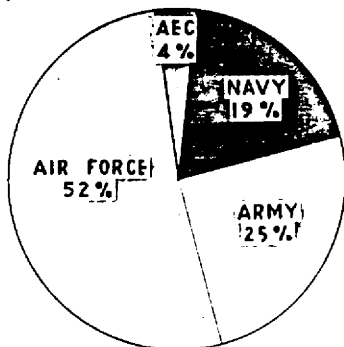

TOTAL \$ 39.6 M

DIRECT

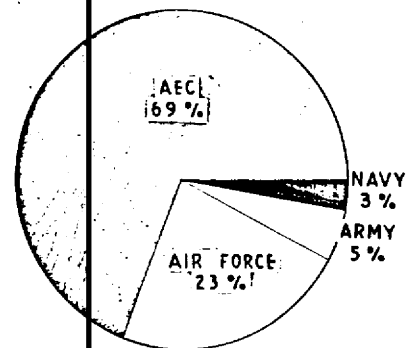

TOTAL \$ 70.4 M

CUMULATIVE REPORTED COSTS THRU 28 FEB 51 30 APR 51

ARMY	\$ 11,239,832	\$ 11,854,480
NAVY	7,542,161	10,228,641
AIR FORCE	31,402,982	40,813,364
AEC	37,174,715	42,377,357
TOTAL	87,359,690	105,379,842

SECRET

Overall Status of Funds FY 1951

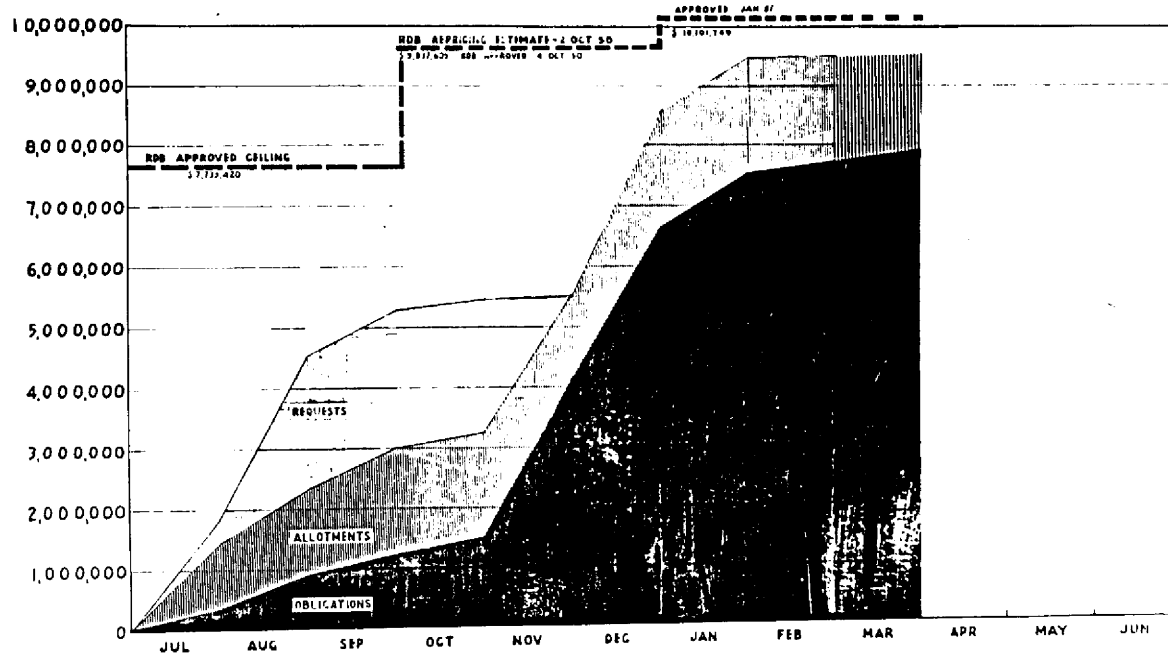

REQUESTS	1,820,014	4,545,399	5,317,357	5,489,787	5,524,245	8,596,436	9,492,076	9,509,246	9,550,296	9,575,296	9,578,882
ALLOTMENTS	1,403,114	2,280,785	3,099,503	3,296,933	5,524,245	8,596,436	9,492,076	9,509,246	9,550,296	9,575,296	9,578,882
OBLIGATIONS	297,310	915,686	1,259,973	1,569,133	4,126,614	6,630,746	7,531,381	7,735,515	7,904,807	8,258,235	8,720,289

NOTE: ALL FIGURES SHOWN ARE CUMULATIVE.
DOES NOT INCLUDE PROGRAM 7.

SECRET

STATISTICAL

Greenhouse Funds Program FY's 50-51

DOD FISCAL YEAR 1951

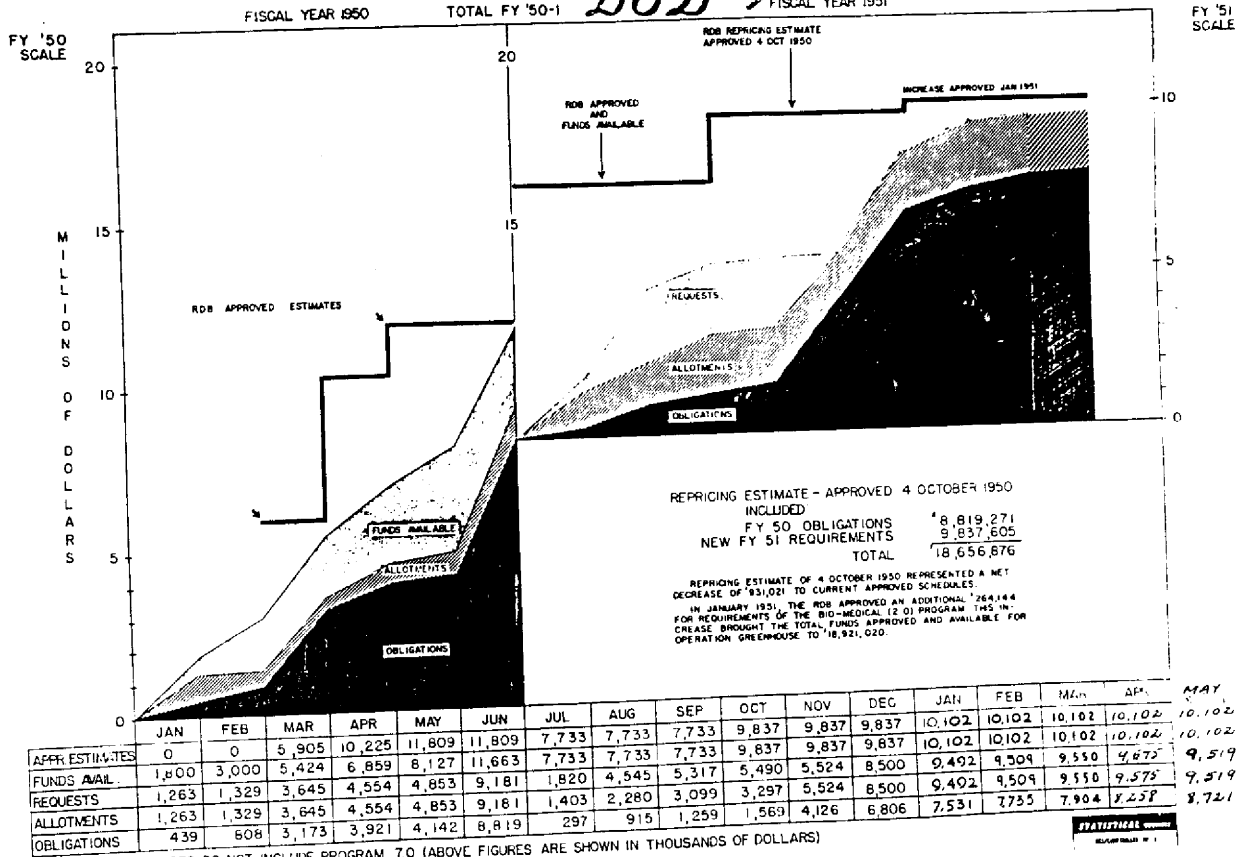

FIGURES DO NOT INCLUDE PROGRAM 7.0 (ABOVE FIGURES ARE SHOWN IN THOUSANDS OF DOLLARS)

SECTION II
COMPTROLLER

~~RESTRICTED~~

ORGANIZATIONAL CHART HEADQUARTERS AIR TASK GROUP 3.4 PROVISIONAL

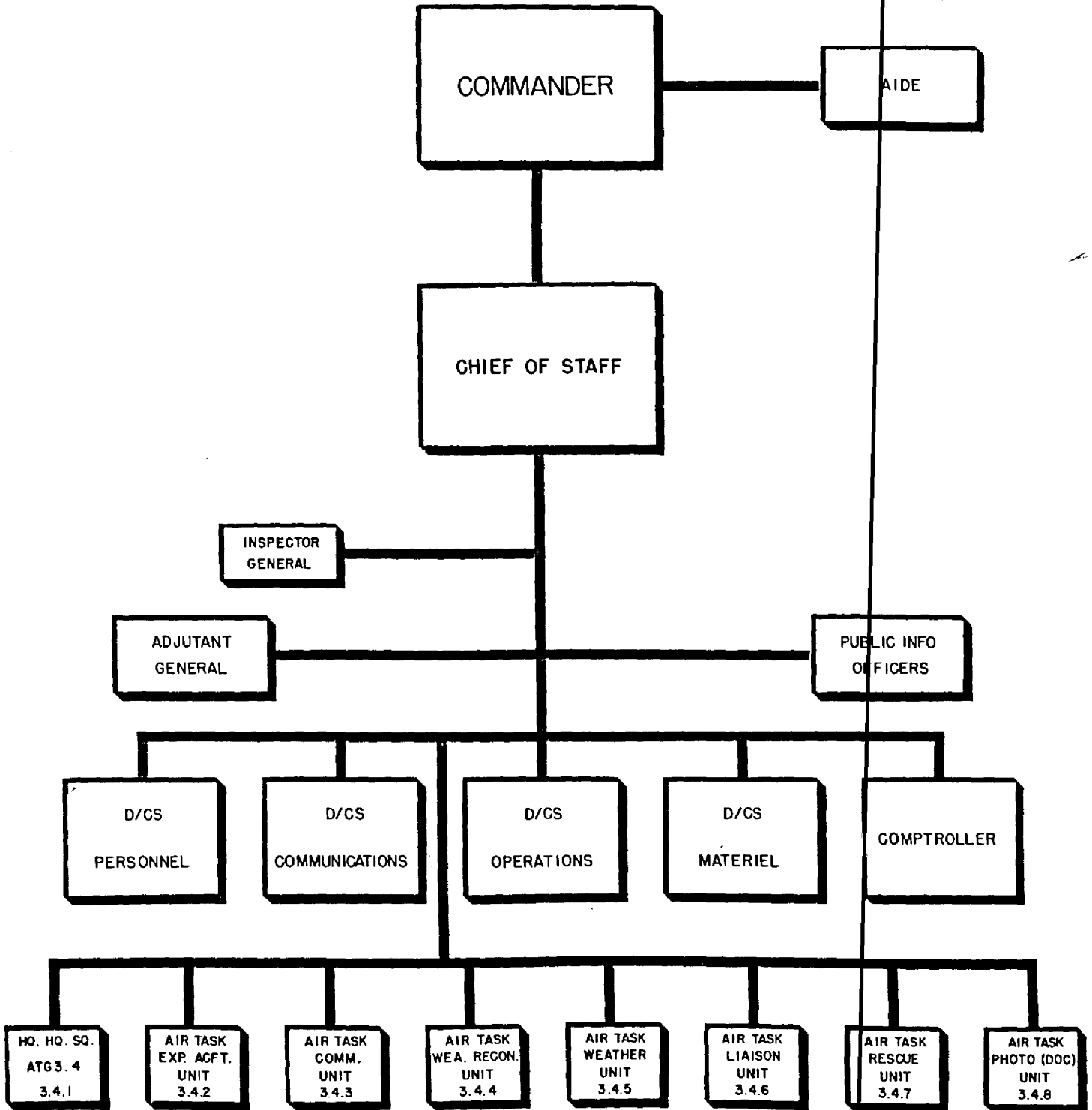

DECLASSIFIED

E.O. 10501, NOV. 6, 1953

NLE BY _____ DATE _____

DECLASSIFIED

~~RESTRICTED~~ E.O. 10501, NOV. 6, 1953

DATE _____

STATISTICAL INFORMATION
CLASSIFIED BY 1

MISSION
TASK GROUP 3.4
(PROPOSED)

PROVIDE AIRCRAFT AND PERFORM MISSIONS AS REQUIRED BY THE ATOMIC ENERGY COMMISSION AND DEPARTMENT OF DEFENSE EXPERIMENTAL PROGRAMS.

PROVIDE GROUND AND AIR WEATHER OBSERVATION AND FORECASTING NECESSARY FOR ACCOMPLISHMENT OF WEAPONS TESTS AND EXPERIMENTAL PROGRAMS.

PROVIDE AIRWAYS AND AIR COMMUNICATION AND SEARCH AND RESCUE SERVICE.

PROVIDE AN AIR PLOT SYSTEM TO AFFORD A CONTINUAL DISPLAY OF THE LOCAL AIR SITUATION PRIOR TO, DURING AND FOLLOWING EACH SHOT.

PROVIDE AN AIRBASE UNIT TO INCLUDE ORGANIZATIONAL AND FIELD MAINTENANCE AND SUPPLY FUNCTIONS, BASE OPERATIONS, CRASH FACILITIES AND TRANSIENT AIRCRAFT SERVICES.

PROVIDE INTRA-ATOLL AIR TRANSPORTATION.

ORGANIZATION
TASK GROUP 3.3

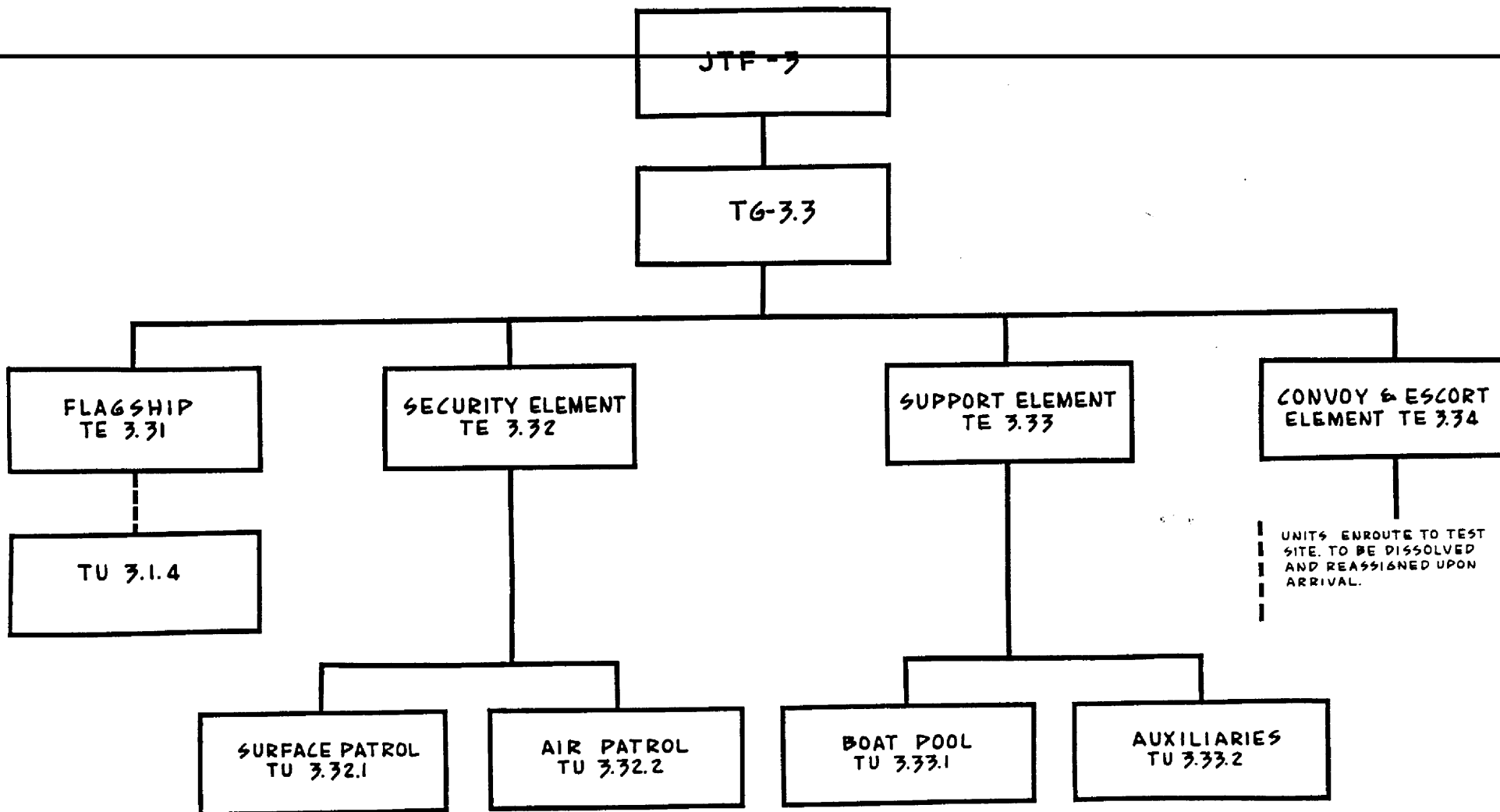

DECLASSIFIED
E.O. 10501, NOV. 6, 1953
FILE BY _____ DATE _____

STATISTICAL REPORT
FORM 8-1

MISSION TASK GROUP 3.3

CONDUCT AERIAL AND SURFACE OPERATIONS FOR SECURITY PURPOSES WITHIN THE ENIWETOK DANGER AREA AS DIRECTED.

PROVIDE SUITABLE WATER TRANSPORTATION AND SHIP-BOARD WEAPON ASSEMBLY FACILITIES FOR EXPERIMENTAL WEAPONS TO MEET THE REQUIREMENTS OF CTG 3.1.

PROVIDE AN AUXILIARY COMMAND POST FLOAT FOR THE TASK FORCE COMMANDER INCLUDING STANDBY FACILITIES FOR COMMUNICATIONS AND AIR CONTROL.

PROVIDE ADMINISTRATIVE AND LOGISTIC SUPPORT NECESSARY TO MAKE CTG 3.3 SELF-SUFFICIENT.

CONTROL HARBOR FACILITIES AT ENIWETOK ATOLL IN COORDINATION WITH TG 3.2.

BE PREPARED TO AUGMENT FACILITIES FOR INTRA-ATOLL WATER TRANSPORTATION AND TO ASSIST IN CARGO HANDLING OPERATIONS AT ENIWETOK ATOLL.

ASSIST TG 3.4 IN THE MAINTENANCE OF NAVAL AIRCRAFT PARTICIPATING IN PROJECT 5.2.

STATISTICAL
REQUIREMENTS

SECRET.

TASK GROUP 3.2 (1 OCT 1950)

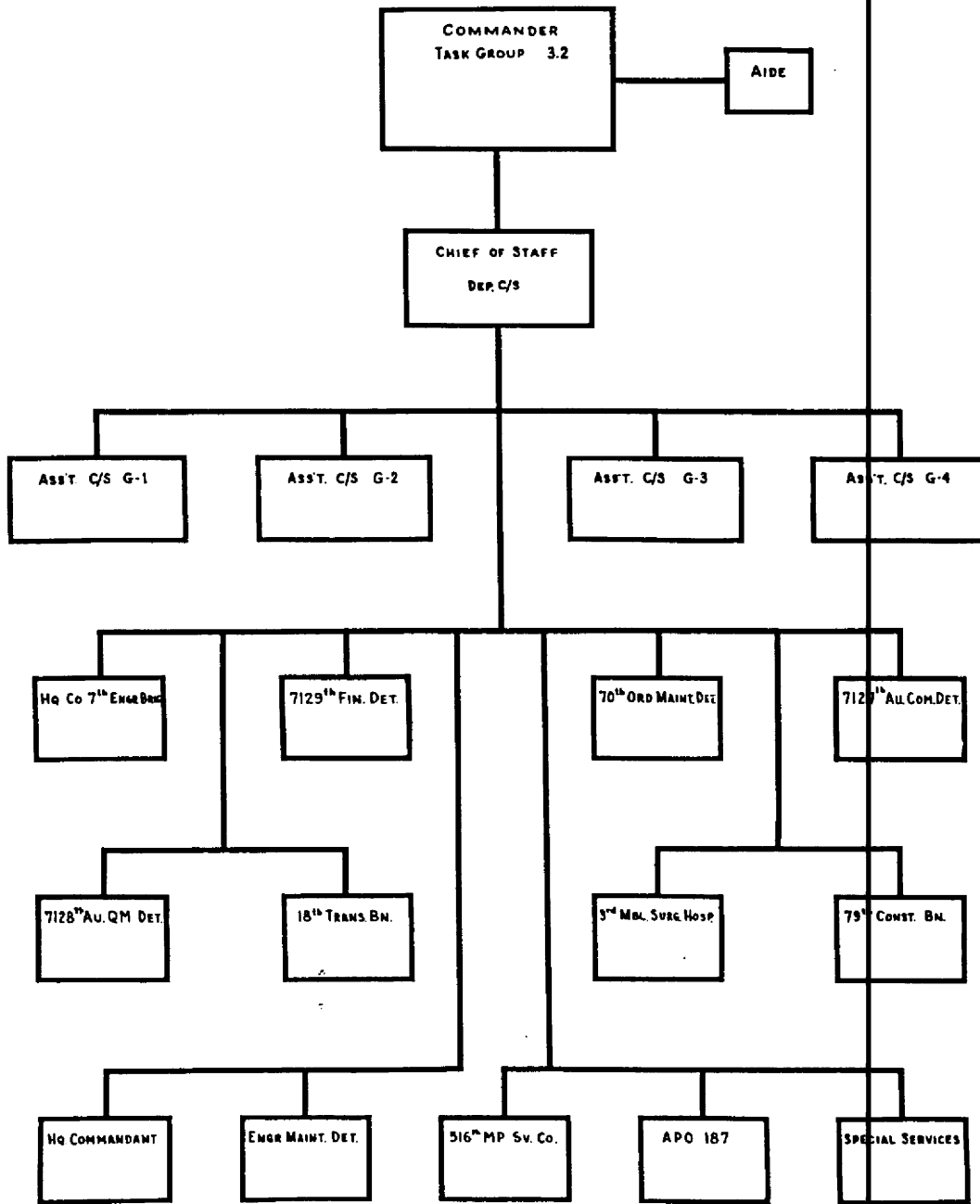

DECLASSIFIED

E.O. 10501, NOV. 6, 1953

FILE BY _____ DATE _____

MISSION

TASK GROUP 3.2

CONTINUE TO CONSTRUCT AND OPERATE FACILITIES ON ENIWETOK ISLAND, AS DIRECTED BY CJTF-3 AND RENDER NECESSARY ASSISTANCE TO TG 3.1 WITH THE MEANS AVAILABLE.

CONTINUE TO DISCHARGE CURRENT RESPONSIBILITIES OF ATCOM-ENIWETOK AS DIRECTED BY CINCPAC.

OPERATIONAL PHASE:

OPERATE AND MAINTAIN ALL FACILITIES ON ENIWETOK ISLAND EXCLUSIVE OF FACILITIES DIRECTLY RELATED TO THE OPERATION OF AIRCRAFT (TO BE OPERATED BY TG 3.4) AND CERTAIN LABORATORY AND SPECIFIED UTILITIES (TO BE OPERATED BY 3.1).

OPERATE PORT FACILITIES AT THE ENIWETOK ATOLL IN COORDINATION WITH TG 3.3.

INSURE THE PHYSICAL SECURITY OF THE ISLANDS OF THE ENIWETOK ATOLL TO INCLUDE THE SECURITY OF EXCLUSION AREAS. ESTABLISH AND OPERATE A SUITABLE TRAFFIC CONTROL POINT AT KWAJALEIN IN THE EXECUTION OF THE SECURITY MISSION IN COORDINATION WITH REQUIREMENTS ESTABLISHED BY CTG 3.1.

PROVIDE LOGISTICAL SUPPORT AND ASSISTANCE AS REQUIRED TO UNITED STATES COAST GUARD "LORAN" DETACHMENT.

CHIEF OF
STAFF
S.W. Burriss

D-1
PERSONNEL
ADMINISTRATION
Dr. K. Stephenson
L. Col. D. Williams
A. W. Kelly
L. Burns
Capt. A. S. Knouf

D-2
INTELLIGENCE
& SECURITY
W.R. Adair
J.F. Brantley
D.M. Butler

D-3
PLANS &
OPERATIONS
Dr. J.C. Clark
D. Curry
Maj. J.R. Boswell

D-4
SUPPLY &
LOGISTICS
H.S. Allen
Maj. H. Freshwater
Maj. J.C. Woodburn

D-5
SCIENTIFIC
ADVISORY GROUP
Dr. B.R. Suydam
Capt. P.G. Galentine

TU 3.1.1
PROGRAM 1.0
LOS ALAMOS
EXPERIMENTS
Dr. F. Reines
LASL

TU 3.1.2
PROGRAM 2.0
BIO-MEDICAL
Dr. G. LeRoy
Hines VA Hosp.
Dr. W. Langham
LASL

TU 3.1.3
PROGRAMS
3.0 - 8.0
Col. R.E. Jarmon
LASL

TU 3.1.4
WEAPONS
ASSEMBLY
R.W. Henderson,
Sandia

TU 3.1.5
RAD-SAFE
Br. Gen. J.P. Cooney
DMA
Dr. T.N. White
LASL

TU 3.1.6
PHOTOGRAPHY
L.M. Gardner,
LASL

TU 3.1.7
BASE
FACILITIES
P.W. Spain,
LASL

J-7 ADVISORY
GROUP
B. Briant
Dr. D. Hall
Dr. W. Ogile
Dr. L. Seely
Dr. B. Watt
E. Zedeno

21 JAPAN ISLAND
DEVELOPMENT
Dr. J.C. Clark,
LASL

PROGRAM 3
STRUCTURES
Sherwood Smith
OCE
L. Cdr. W. Rowen
LASL

PROGRAM 4
CLOUD PHYSICS
Dr. P.H. Wyckoff,
AFCL

PROGRAM 5
RADIOLOGICAL
INSTRUMENT
EVALUATION
L. Cdr. V. Delano
LASL

PROGRAM 6
PHYSICAL TESTS
& MEASUREMENT
L. Cdr. V. Delano
LASL

PROGRAM 7
LONG RANGE
DETECTION
Dr. D. Rock
AFOAT-1

PROGRAM 8
EFFECTS ON
AIRCRAFT
Col. R.E. Jarmon
LASL

11 PROMPT GAMMA
RAY MEASUREMENTS
Dr. W. Hall, NRL

22 ANIMAL
PRODUCTION
Maj. R. Veensira,
VC, USA

311 MULTI-STORY
Maj. B. Jones,
OCE

41 ATOMIC CLOUD
DOCUM. PROJECT
C. Anderson,
AFCL

51 RADIOLOG. DETECT.
DEVICE SERV. TEST
C. Clayton,
GCSC

61 CLOUD PARTICLE
SIZE & DISTRIBUTN
J. Mitchell,
ACC

81 AIRBORNE
AIRCRAFT
J. Wayne, AMC

12 DELAYED GAMMA
RAY MEASUREMENTS
Dr. L. Taylor, NBS

23 EXPOSURE
EQUIPMENT
Capt. R. Dreger,
NMRI

312 REINFORCED
CONCR. SHELTERS
Maj. B. Jones,
OCE

42 WIND
PHENOMENA
R. Rados,
AMC

52 AIRBORNE
RAD EQUIPMENT
L. Cdr. L. Siss,
Bu. Aer.

62 THERM EFFECT
ON MATERIALS
Dr. P. Tompkins,
NRDL

82 AIRCRAFT PANEL
STATIC TESTS
D. Grimes, AMC

13 THERMAL RAD.
MEASUREMENTS
Dr. W. HALL, NRL

2412 ACUTE RAD.
MICE
L. Cdr. E. Cronkite,
NMRI

321 BOMBPROOF
ROOF
L. Cdr. S. Rockefeller,
Bu. Y. D.

45 TROPICAL
METEOROLOGY
C. Palmer,
UCLA

53 AIRBORNE
EXPOSURE
Dr. L. Delano,
APG

63 VEHICLE
EXPOSURE
Dr. L. Delano,
APG

83 Radar Scope
Photography
F. L. Holloway,
AMC

14 VISIBLE RAD.
MEASUREMENTS
Dr. H. Grier, E.G.G.
Dr. W. Hall, NRL

2413 HISTOLOGY,
DOGS
Col. E. DeCoursey,
AMC

322 CONCR WITH
PANEL VENEER
L. Cdr. S. Rockefeller,
Bu. Y. D.

46 ATMOSPHERIC
CONDUCTIVITY
S. Coranelli,
AFCL

54 FALL-OUT
DISTRIBUTION
Dr. P. Tompkins,
NRDL

64 SURVEY METER
INTERPRETATION
Dr. P. Tompkins,
NRDL

151 NEUT. SPECTR
& AIR ATTENUATN
Dr. W. Ogile, LASL
Dr. L. Rosen, LASL

2414 LDx,
SWINE
Cdr. J. Tullis,
NMRI

323 MATCH-BOX
L. Cdr. S. Rockefeller,
Bu. Y. D.

47 ATMOSPHERIC
CONDUCTIVITY
S. Coranelli,
AFCL

55 AIRBORNE
EXPOSURE
Dr. L. Delano,
APG

65 FILTER MAT'L
EVALUATION
E. Engquist,
ACC

152 HIGH-ENERGY
SPECTRUM
Dr. W. Hall, NRL

2415 LDx,
DOGS
Col. E. DeCoursey,
AMC

324 PRE-CAST
MAGAZINE
L. Cdr. S. Rockefeller,
Bu. Y. D.

48 ATMOSPHERIC
CONDUCTIVITY
S. Coranelli,
AFCL

56 AIRBORNE
EXPOSURE
Dr. L. Delano,
APG

66 ALDOFT CONTAM
& DECONT STUDIES
Dr. P. Tompkins,
NRDL

153 ENERGY ALPHA
Dr. E. Krause, NRL
Dr. D. Hall, LASL

242 THERMAL
BURST STUDY
Dr. H. Pearce,
U of Rochester

325 CONCRETE
L. Cdr. S. Rockefeller,
Bu. Y. D.

49 ATMOSPHERIC
CONDUCTIVITY
S. Coranelli,
AFCL

57 AIRBORNE
EXPOSURE
Dr. L. Delano,
APG

67 CLOUD RAD'N
FIELD
Dr. P. Tompkins,
NRDL

16 BLAST
MEASUREMENT
Dr. G. Hartmann,
NBS
Dr. H. Grier, E.G.G.
L. Col. A. Fraich
AFSWP
Maj. F. Porel
LASL

243 HEMATOLOGY
Lt. Cdr. E. Cronkite,
NMRI

326 PRE-CAST
CONCRETE DOME
L. Cdr. S. Rockefeller,
Bu. Y. D.

50 ATMOSPHERIC
CONDUCTIVITY
S. Coranelli,
AFCL

58 AIRBORNE
EXPOSURE
Dr. L. Delano,
APG

68 PROTECTIVE
CLOTHING
L. Col. F. Sreedman,
O QMG

17 RADIOCHEMICAL
DETERMINATIONS
Dr. R. Spence, LASL

244 PHANTOM
DOSIMETRY
Lt. Cdr. F. Chambers,
NMRI

327 CONCRETE,
TYPE H
L. Cdr. S. Rockefeller,
Bu. Y. D.

51 ATMOSPHERIC
CONDUCTIVITY
S. Coranelli,
AFCL

59 AIRBORNE
EXPOSURE
Dr. L. Delano,
APG

69 PROT. EQUIPM,
COLLECTIVE, EVAL.
B. Kerpel,
ACC

18 RADIOCHEMICAL
DETERMINATIONS
Dr. R. Spence, LASL

2511 SURVIVAL
STUDY, MICE

333 INDUSTRIAL,
LONG SPAN
Maj. B. Pettit,
AMC

52 ATMOSPHERIC
CONDUCTIVITY
S. Coranelli,
AFCL

60 AIRBORNE
EXPOSURE
Dr. L. Delano,
APG

70 PROT. EQUIPM,
COLLECTIVE, EVAL.
B. Kerpel,
ACC

18 X-RAYS
Dr. R. Spence, LASL

254 FISSION PROD.
DISTRIBUTION

334 INDUSTRIAL
SHORT SPAN
Maj. B. Pettit,
AMC

53 ATMOSPHERIC
CONDUCTIVITY
S. Coranelli,
AFCL

61 AIRBORNE
EXPOSURE
Dr. L. Delano,
APG

71 PROT. EQUIPM,
COLLECTIVE, EVAL.
B. Kerpel,
ACC

TASK GROUP 3.1
JOINT TASK FORCE 3

MEASUREMENTS
Dr. H. Grier, EGG
Dr. W. Hall, NRL

DOGS
Col. E. DeCoursey, AMC

S. Coroniti, AFCL

Dr. P. Tompkins, NRDL

1.51 NEUT. SPECTR
B AIR ATTENUATN
Dr. W. Osh, LASL
Dr. L. Rosen, LASL

2414 LD1, SWINE
Cdr. J. Tullis, NMRI

3.23 MATCH-BOX
L. Cdr. S. Rockefeller,
Bu. Y. D.

6.5 SURVEY METER
INTERPRETATION
Dr. P. Tompkins,
NRDL

1.52 HIGH-ENERGY
SPECTRUM
Dr. W. Osh, LASL

2415 LD1, DOGS
Col. E. DeCoursey, AMC

3.24 PRE-CAST
MAGAZINE
L. Cdr. S. Rockefeller,
Bu. Y. D.

6.6 FILTER MAT'L
EVALUATION
E. Engquist, ACC

1.53 ENERGY-ALPHA
Dr. E. Krause, NRL
Dr. D. Hall, LASL

242 THERMAL
BURN STUDY
Dr. H. Peppers,
U of Rochester

3.25 CONCRETE
ARCH
L. Cdr. S. Rockefeller,
Bu. Y. D.

6.7 ALOFT CONTAM
& DECONT STUDIES
Dr. P. Tompkins
NRDL

1.6 BLAST
MEASUREMENT
Dr. G. Hartman,
NOBL
Dr. H. Grier, EGG
L. Col. A. Frisch
AFSWP
Maj. F. Porzel
LASL

243 HEMATOLOGY
Lt. Cdr. E. Cronkite
NMRI

3.26 PRE-CAST
CONCRETE DOME
L. Cdr. S. Rockefeller,
Bu. Y. D.

6.8 CLOUD RADIN
FIELD
Dr. P. Tompkins,
NRDL

1.7 RADIOCHEMICAL
DETERMINATIONS
Dr. R. Spence, LASL

2511 SURVIVAL
STUDY, MICE

3.27 CONCRETE,
TYPE "H"
L. Cdr. S. Rockefeller,
Bu. Y. D.

6.9 PROTECTIVE
CLOTHING
L. Col. F. Steadman,
OQMG

1.8 X-RAYS
Dr. H. Brauner
Dr. H. York
UCRL

254 FISSION PROD
DISTRIBUTION
Dr. R. Carter, LASL

3.34 INDUSTRIAL
SHORT SPAN
Maj. B. Pettit,
AMC

6.10 PROT. EQUIPM.,
COLLECTIVE, EVAL.
B. Karpel, ACC

2551 BIOL. DOSIM.,
TRADESCANTIA
Dr. A. Conger,
ORNL

3.35 LOAD-
BEARING WALL
Maj. B. Pettit,
AMC

2552 BIOL. DOSIM
ASPERGILLUS
Dr. Stapleton,
ORNL

3.3 B SCALE
STRUCTURES
Maj. B. Pettit,
AMC

2553 BIOL. DOSIM,
CORN & MISC
Dr. G. Beadle,
Cal. Tech.

3.4 STRUCTURES
INSTRUMENTATN
H.E. Leonard,
Sandia

2554 BIOL. DOSIM,
MICE, T
Dr. R. Carter,
LASL

2555 BIOL. DOSIM,
MICE, NEUTRONS
Dr. R. Carter,
LASL

256 GENETICS
STUDIES
Dr. G. Beadle,
Cal. Tech.

257 BIOTIC
STUDIES
Dr. L. Donaldson,
Univ. Washington

TASK GROUP 3.1
JOINT TASK FORCE 3

KEY TO ABBREVIATIONS

A	ACC	Army Chemical Center	O	OCE	Office of Chief of Engineers
	AFCL	Air Force Cambridge Research Laboratory		OCSC	Office of Chief of Signal Corps
	AFOAT	Air Force Office for Atomic Tests		OQMG	Office of Quartermaster General
	AFSWP	Armed Forces Special Weapons Project		ORNL	Oak Ridge National Laboratory
	AMC	Air Materiel Command	U		
	APG	Aberdeen Proving Ground	UCLA		University of California, Los Angeles
B	Bu. Aer	Bureau of Aeronautics	UCRL		University of California, Radiation Laboratory
	Bu. Y. D.	Bureau of Yards and Docks	USA		United States Army
E	EGG	Edgerlon, Germeshausen, and Grier, Inc.	USAF		United States Air Force
L	LASL	Los Alamos Scientific Laboratory	USN		United States Navy
N	NBS	National Bureau of Standards	VC		Veterinary Corps
	NMRI	Naval Medical Research Institute	D		
	NOBL	Naval Ordnance & Ballistics Research Laboratories	DMA		Division of Military Applications
	NRL	Naval Research Laboratory			
	NRDL	Naval Radiological Defense Laboratory			

SECRET

[Handwritten signature]

[Faint handwritten notes]

THIS DOCUMENT CONSISTS OF 1 PAGE(S)
NO. 19 OF 30 COPIES, SERIES B
LAB J-6S c
4-19-50

SECRET

18

TASK GROUP 3.1

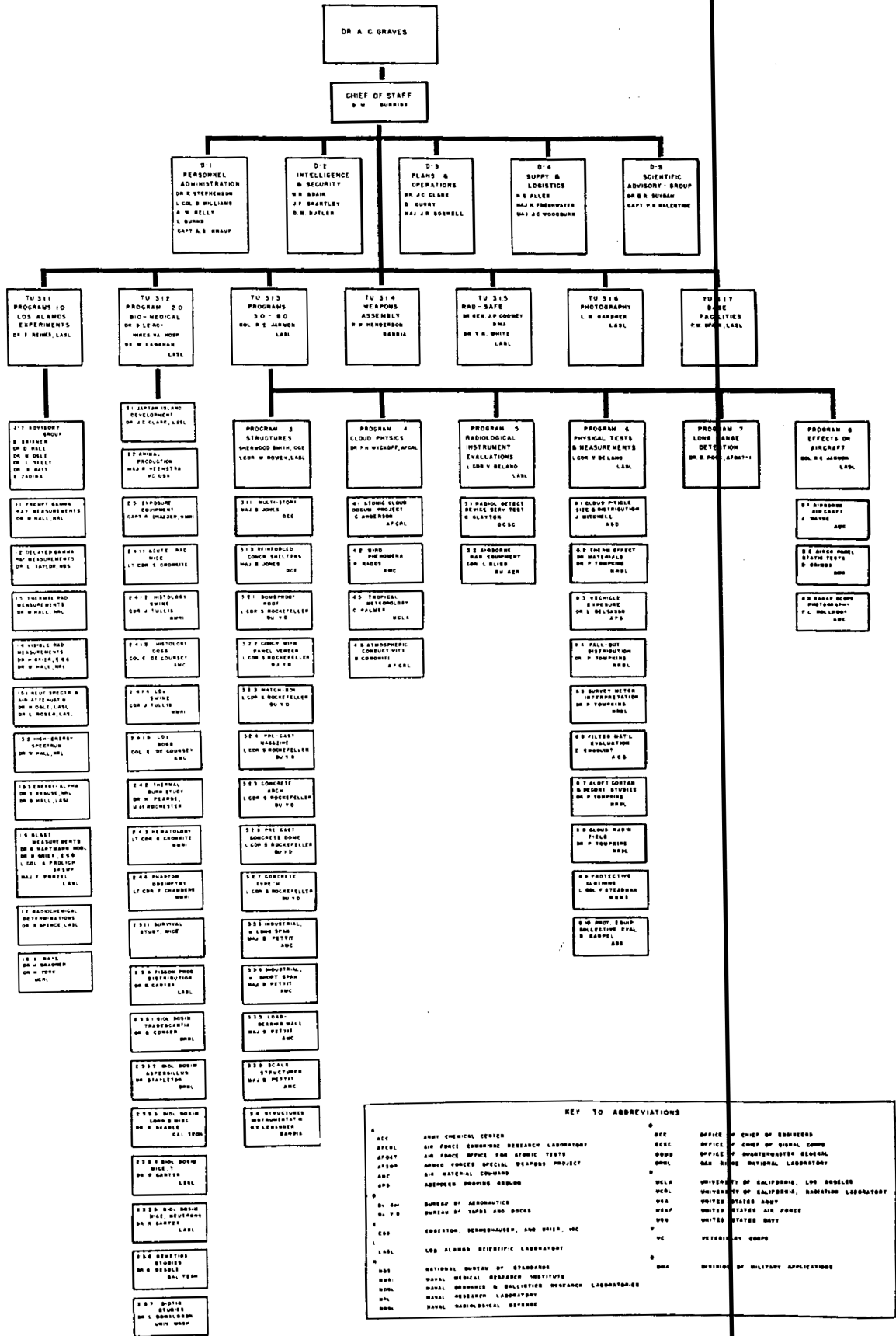

KEY TO ABBREVIATIONS

A	ARMY CHEMICAL CENTER	O	OFFICE OF CHIEF OF DEFENSE
AFCL	AIR FORCE CHEMISTRY RESEARCH LABORATORY	O	

TASK GROUP 3.1

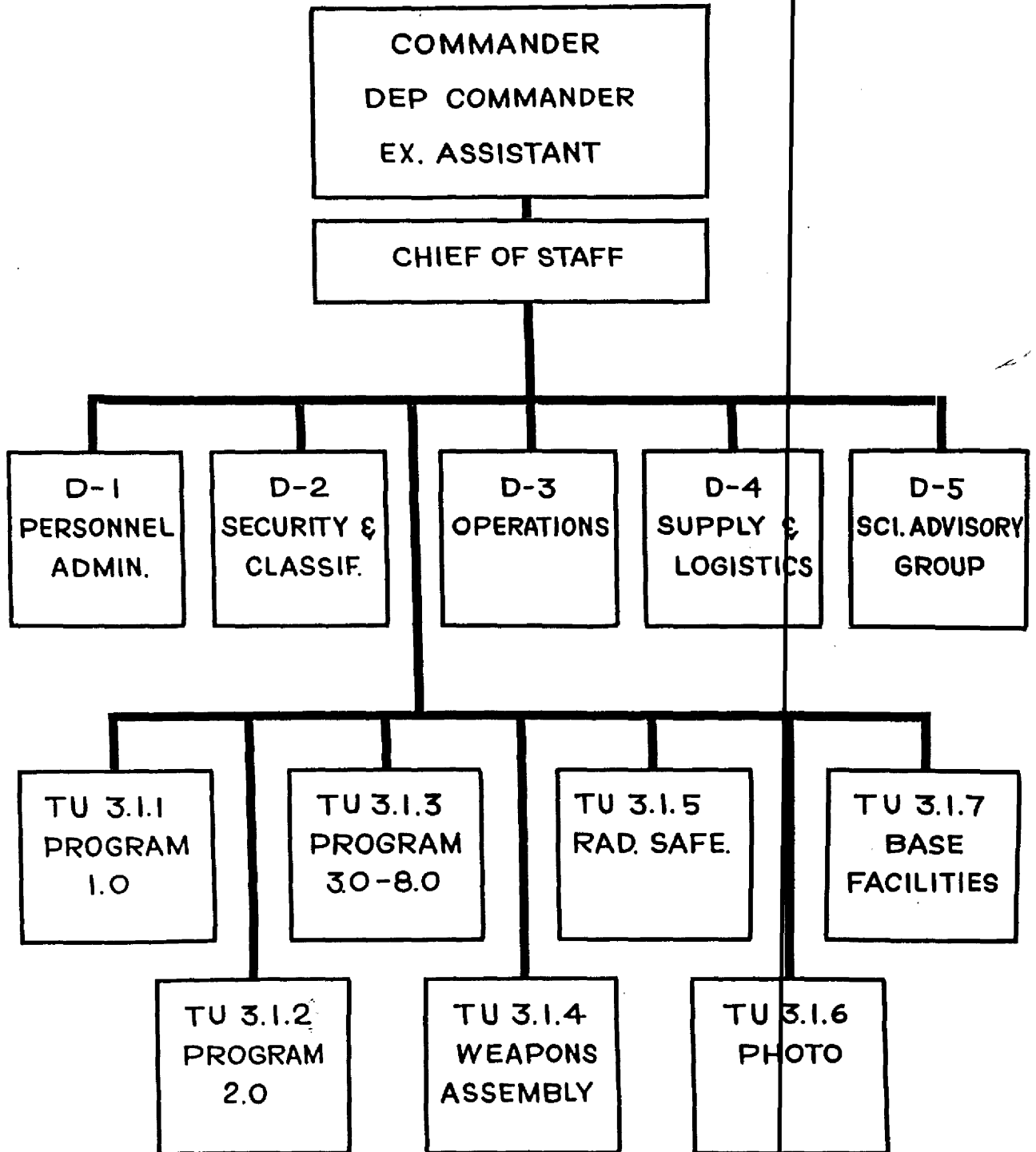

MISSION TASK GROUP 3.1

PREPARE, ARM AND FIRE NUCLEAR WEAPONS AND OTHER DEVICES WHEN DIRECTED BY CJTF-3.

PREPARE FOR AND CONDUCT THE EXPERIMENTAL PROGRAM (PROGRAM 1.0) OF THE AEC.

PREPARE FOR AND CONDUCT THE COMBINED ATOMIC ENERGY COMMISSION-DEPARTMENT OF DEFENSE BIO-MEDICAL PROGRAM (PROGRAM 2.0).

PREPARE FOR AND CONDUCT THE EXPERIMENTAL PROGRAMS (PROGRAMS 3.0 THRU 6.0 AND PROGRAM 8.0) OF THE DEPARTMENT OF DEFENSE.

ASSUME OPERATIONAL AND TECHNICAL CONTROL OF PROGRAM 7.0 (LONG RANGE DETECTION ACTIVITIES) ON ENIWETOK ATOLL AND COORDINATE THE EXPERIMENTAL PHASES OF PROGRAM 7.0 ACTIVITIES AT MAJURO, RONGERIK, BIKINI AND KWAJALEIN WITH HEADQUARTERS, USAF (AFOAT-1).

PROVIDE FOR THE DESIGN OF INSTALLATIONS ON ALL ISLANDS OF THE ENIWETOK ATOLL, CONSTRUCTION ON ALL ISLANDS OF THE ENIWETOK ATOLL EXCEPT ENIWETOK ISLAND, AND ASSISTANCE TO INCLUDE SUPPLY OF CERTAIN MATERIALS TO CTG 3.2 IN CONSTRUCTION OF FACILITIES ON ENIWETOK ISLAND AS AGREED WITH CTG 3.2.

OPERATE AND MAINTAIN BASE AND LABORATORY FACILITIES ON ALL ISLANDS OF THE ENIWETOK ATOLL EXCEPT ENIWETOK ISLAND AND OPERATE AND MAINTAIN CERTAIN LABORATORY FACILITIES AND SPECIFIED UTILITIES ON ENIWETOK ISLAND.

STATISTICAL SERVICE
SECURITY/CONTROL PT 3

SECRET

42

JOINT TASK FORCE THREE

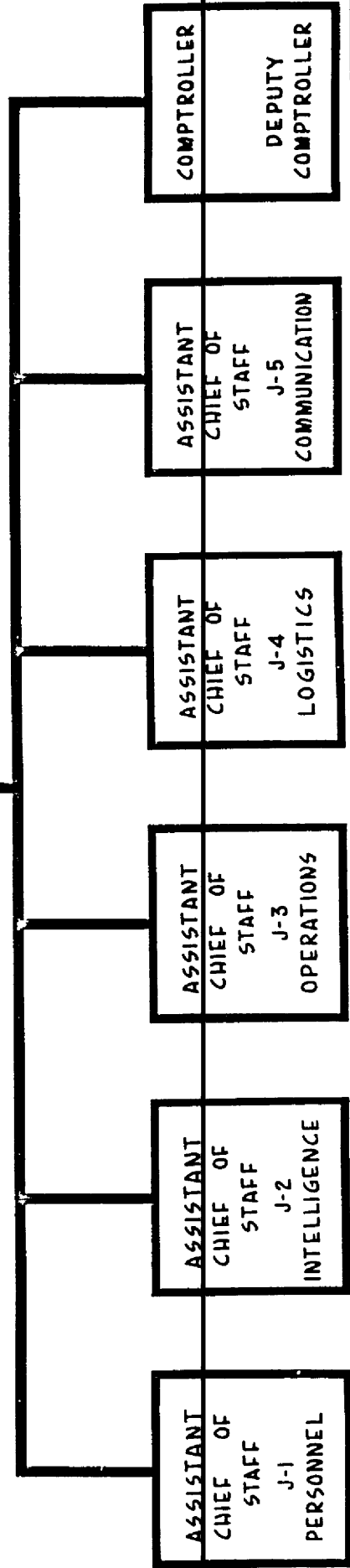
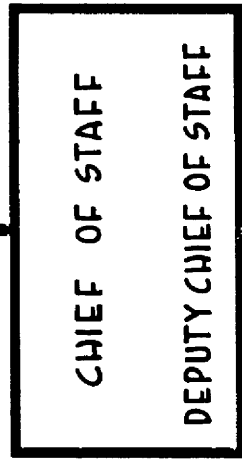
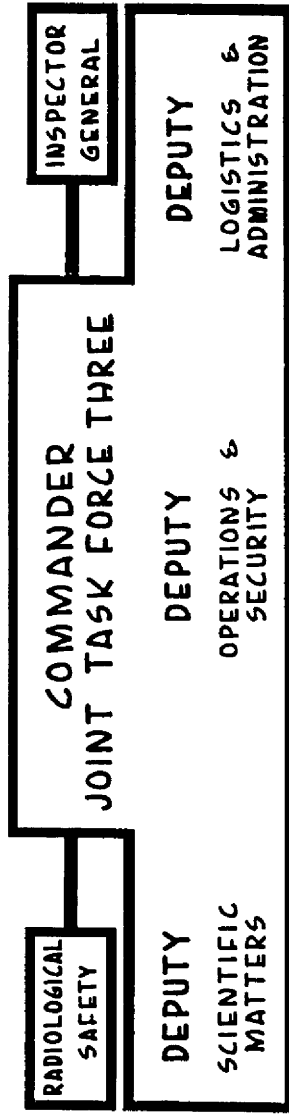

STATISTICAL SYMBOL
 (Symbolic)

JOINT TASK FORCE THREE

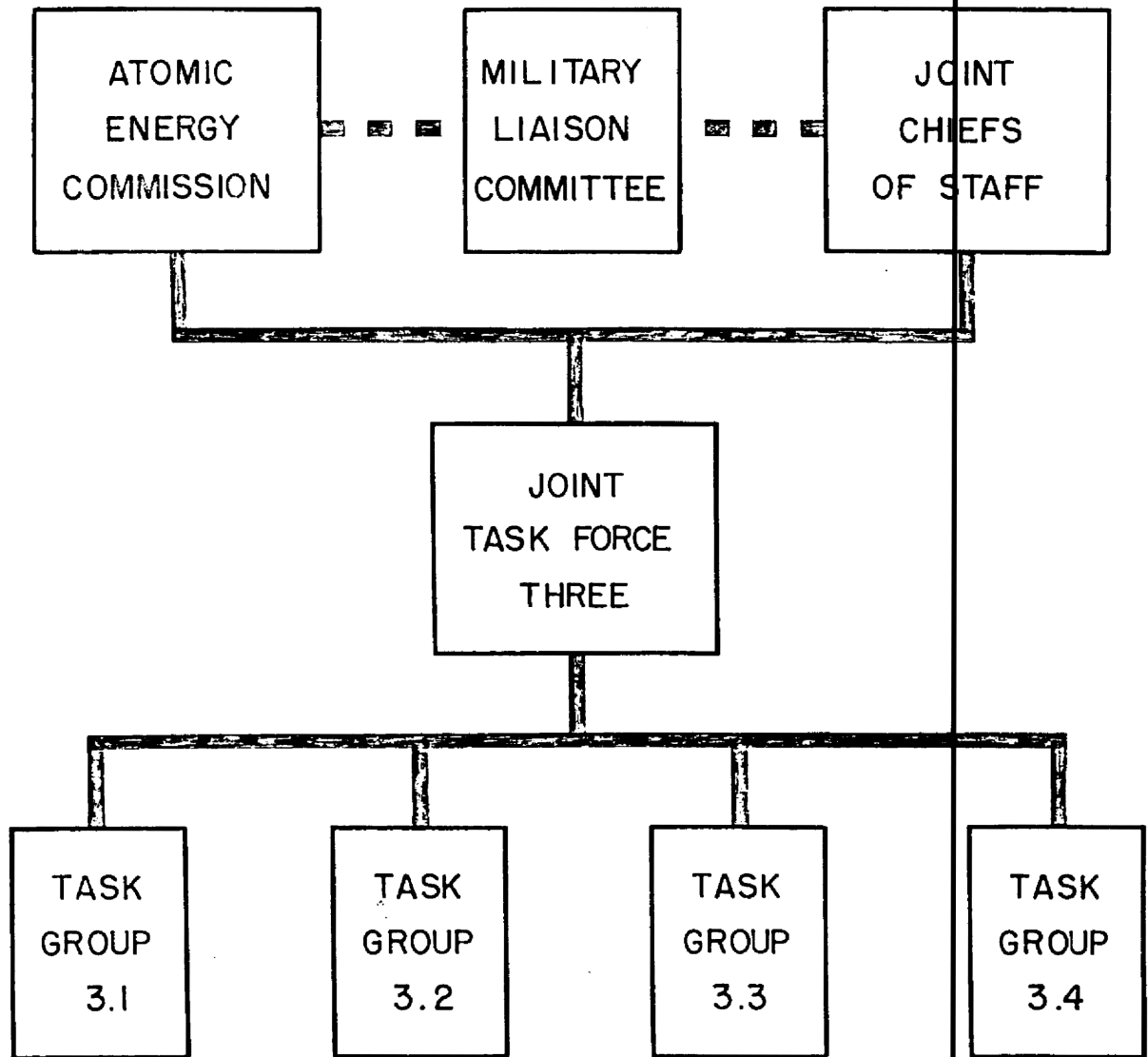

JOINT TASK FORCE THREE

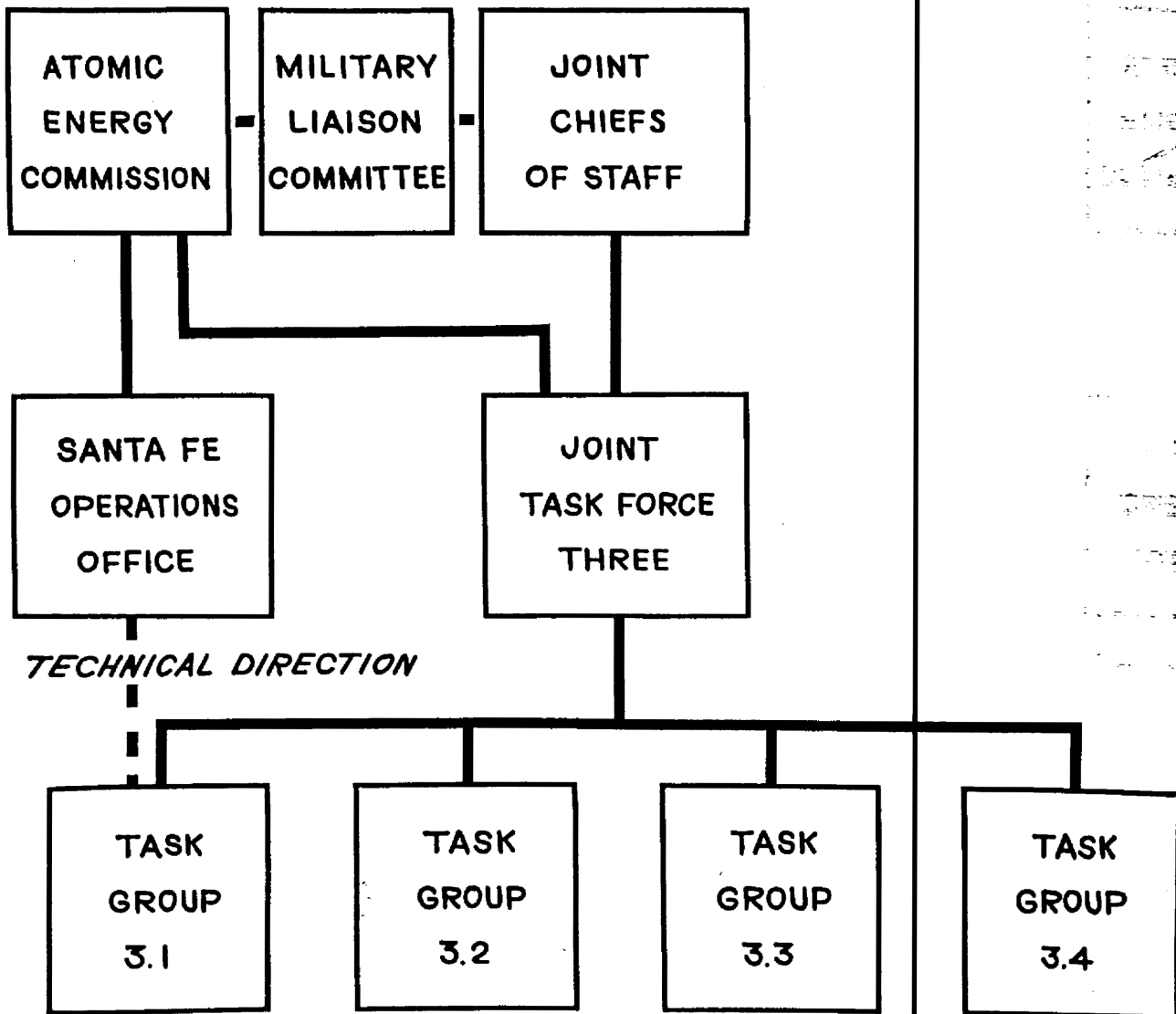

DECLASSIFIED

E.O. 10501, NOV. 6, 1953

FILE BY _____ DATE _____

~~SECRET~~

JOINT TASK FORCE THREE

Page . . . 1

MISSION

To prepare for and conduct test of four (4) experimental atomic weapons (and of a fifth such weapon if required) commencing on or about 15 April 1951.

To prepare for and conduct the experimental measurements proposed by the Atomic Energy Commission, and so much of the experimental programs proposed by the ARMY, the NAVY and AIR FORCE (and other interested agencies) as may subsequently be approved by the Joint Chiefs of Staff.

On assumption of overall military responsibility for ENIWETOK ATOLL, provide for local security of the ENIWETOK AREA.

~~SECRET~~

46

SECTION I

ORGANIZATIONS AND MISSIONS

STATISTICAL SERVICE

DCS/COMPTROLLER - III - 3

~~SECRET~~

~~SECRET~~



DEPARTMENT OF THE AIR FORCE
HEADQUARTERS UNITED STATES AIR FORCE
WASHINGTON 25, D. C.

16 MAR 1950

SUBJECT: Armed Forces Participation in 1951 Atomic Weapons
Proof-Testing

TO: Commander
Joint Task Force THREE
Main Navy Building
Washington 25, D. C.

1. The Joint Chiefs of Staff have approved the recommendations contained in J.C.S. 1998/13. The Atomic Energy Commission has concurred in those aspects of the plan set forth in J.C.S. 1998/13, which are pertinent to the Commission's activities.
2. You are directed to integrate into Joint Task Force THREE such units and personnel as may be made available by the Chief of Staff, U. S. Army, the Chief of Staff, U. S. Air Force, the Chief of Naval Operations, and the Atomic Energy Commission.
3. The mission of Joint Task Force THREE is:
 - a. To prepare for and conduct tests of three experimental atomic weapons commencing on or about 1 March 1951.
 - b. To prepare for and conduct the experimental measurements proposed by the Atomic Energy Commission, and so much of the experimental programs proposed by the Army, the Navy and the Air Force (and other interested agencies) as may subsequently be approved by the Joint Chiefs of Staff.
 - c. On assumption of over-all military responsibility for Eniwetok Atoll, provide for local security of the Eniwetok area.
4. You may, at your discretion, and within the limitations of funds made available to you therefor, include such other experiments consistent with the approved programs which do not jeopardize the scope thereof, and you may delete experiments which may subsequently prove undesirable or not feasible.
5. At a time to be designated by you, you will arrange with CinCPAC to assume over-all military responsibility for Eniwetok Atoll, the atomic weapons proving ground established thereon, and the operational control of all units, personnel and facilities made available

for this test. In the accomplishment of your mission, you will take action as necessary to enforce the status of Eniwetok Atoll which was closed effective 1 December 1947, pursuant to the provisions of the Strategic Trusteeship Agreements for the Trust Territory of the Pacific Island.

6. On assuming military responsibility for the Eniwetok area, you will take appropriate action to deny entry to all unauthorized personnel, aircraft and vessels. In carrying out this mission, you are authorized to use all means available to you (including firing of warning shots and, in the case of a submerged submarine, dropping depth charges aimed not to hit, when all normal means of warning and identification have been exhausted).
7. You will prepare, submit to the Joint Chiefs of Staff for approval, and keep up to date, plans for a general emergency (including plans for rapid redeployment of your forces on call from the Joint Chiefs of Staff).
8. You will keep the Joint Chiefs of Staff informed of your progress and you will submit a report of the activities of Joint Task Force THREE upon completion of the operation.
9. Direct communication is authorized with the three military Services, CINCPAC, other commanders of unified commands, and the Atomic Energy Commission, on all matters pertaining to the implementation of the plan contained in J.C.S. 1998/13.

FOR THE CHIEF OF STAFF, U.S. AIR FORCE, EXECUTIVE AGENT:

S. E. ANDERSON
Major General, USAF
Director, Plans and Operations

~~SECRET~~

~~SECRET~~

PERSONNEL

J-4 Division

Maintenance Supply and Services

Commander Albert B. Howden, USN

Lt. Colonel Robert L. Ely, USA

Captain George T. Carr, USAF

Colonel R. F. Alexander, USA

Commander, John A. Clark, USN

Major Bruce D. Jones, USA

Major Robert D. Denchfield, USA

Major J. G. Stanley, USA

Major Marcus A. Petterson, USA

Captain Bernard J. O'Donnell, USA

Captain Marcus P. Freeman, USA

Major Joseph V. Bledsoe, USAF

Lt. Commander Ernest W. Dobie, USN

Major Andrew Prudhomme

Captain Leroy J. Jones, USAF

Lt. John Lutzelman, USN

Installations

Transportation

Liaison, San Francisco

Liaison, Travis AFB

Liaison, Oahu

Liaison, McClellan AFB

Administration

Comptroller

Budget and Fiscal

Colonel J. M. Ruddy, USA

Planning

Lt. Colonel Francis L. Kohlrieser, USAF

Management Analysis

Major Elta P. Evans, USAF

Statistical Services

Lt. Colonel William T. Shealy, USAF

Major H. T. Boyd, USAF

Captain E. J. Darst, USAF

Audit and Finance

Captain Robert D. Crea, USA

J-5 Division

Frequency Control and Current Section

Colonel Wesley E. Calkins, USAF

Traffic Control Section

Lt. Byron G. Langford, USN

Plans, Personnel and Supply

Major Ernest S. King, USA

Communications Security

Lt. Colonel Burnis M. Kelly, USA

Major Loudin L. Rohr, USAF

Captain Gordon L. Fields, USAF

Lt. Chester Gavin, Jr., USN

Communications Center

Lt. C. F. Grinager, USA

Technical Consultant

Mr. Jack H. Eggert

Mr. Robert J. Spurr

PERSONNEL

Secretary, Joint Staff

Headquarters Commandant	Lt. Wesley Hiron, USN
J-1 Division	
Adjutant General	Colonel Emery W. Cofield, USAF
Assistant Adjutant General	Captain Robert L. Bryant, Jr., USAF
Surgeon	Colonel Charles P. Ward, USA
Chaplain	Colonel L.O. Sheffield, USA
Policy & Personnel Procurement	Lt. Commander John L. Hutchinson, USN
	Captain Francis W. Leaden, USAF
Adjutant General Executive Officer	Major L.A. O'Brien, USA
Top Secret Control Officer	Major Carl M. McIntyre, USA
Administration and Personnel	Lt. Matthew J. Wojcicki, USN
Special Services	Captain William H. McKinney, USAF
Assistant Adjutant General - Mail Center	1st Lt. Francis Zinkand, USAF
Publications & Reproductions	WOJG David G. Walters, USA
Personnel Management	WOJG Otis J. Hingerty, USA
J-2 Division	
Intelligence Estimates	Commander John C. Mathews, USN
Operational Intelligence	Commander W.R. DeLoach, USN
	Lt. Colonel R.B. Rigg, USA
Security	Mr. W. T. Riley, AEC
	Lt. Colonel Ralph H. Currin, USMC
	Lt. Colonel R. G. Minick, USAF
Administration	Lt. Colonel Edwin H. Garrison
J-3 Division	
Chief, Military Operations Branch & Naval Desk	Commander William M. McCormick, USN
Air Force Desk	Lt. Colonel Loren E. Ireland, USAF
Scientific Desk	Lt. Colonel P.L. Hooper, USA
Army Desk	Lt. Colonel Raymond J. Feisinger, USA
Special Projects Desk	Commander Leslie A. Pew, USN
Chief, Technical Operations Branch	Colonel G. R. Taylor, USAF
Weather Desk	Lt. Commander Elbert W. Pate, USN
Radiological-Safety Desk	Commander Russell H. Maynard, USN
Military Tests Desk	Lt. Colonel J. C. Damon, USA
Administrative Executive	1st Lt. William F. Skidmore, USA
Administrative Assistant	WOJG Paul D. Williams, USA
Rear Echelon Representative (Washington D.C.)	Major John B. Corbett

KEY - PERSONNEL

HEADQUARTERS, JOINT TASK FORCE THREE

Commanding General	Lt. General E.R. Quesada, USAF
Aide-de-Camp	Captain Roger F. Haley, USAF
Deputy for Scientific Matters	Dr. Alvin C. Graves, AEC
Executive Deputy for Scientific Matters	Colonel George F. Schlatter, USAF
Deputy, Operations and Security	Rear Admiral Tom B. Hill, USN
Executive Deputy for Operations and Security	Captain Charles B. Martell, USN
Deputy for Logistics and Administration	Brigadier General Herbert B. Loper, USA
Special Assistant to the Commander for Radiological Safety	Brigadier General James P. Cooney, USA
Chief of Staff	Brigadier General John K. Gerhart, USAF
Deputy Chief of Staff	Captain James R. Pahl, USN
Secretary, Joint Staff	Major Vito S. Pedone, USAF
Assistant Chief of Staff, J-1	Colonel Thomas E. Barbour, USA
Deputy Assistant Chief of Staff, J-1	Colonel Maxwell H. Thompson, USA
Assistant Chief of Staff, J-2	Lt. Colonel Roland M. Gleszer, USA
Deputy Assistant Chief of Staff, J-2	Commander John C. Mathews, USN
Assistant Chief of Staff, J-3	Colonel Paul T. Preuss, USAF
Deputy Assistant Chief of Staff, J-3	Colonel Robert R. Gileon, Jr., USAF
Assistant Chief of Staff, J-4	Colonel William E. Pheris, USA
Deputy Assistant Chief of Staff, J-4	Colonel Robert F. Alexander, USA
Assistant Chief of Staff, J-5	Colonel Leland H. Stanford, USA
Deputy Assistant Chief of Staff, J-5	Colonel Wesley E. Calkins, USAF
Assistant Chief of Staff, Comptroller	Colonel Edward J. Hopkins, USAF
Deputy Assistant Chief of Staff, Comptroller	Commander George T. Waite, USN
Inspector General	Colonel Frederick A. Bacher, USAF
Historian	Dr. Henry L. Bowen
Administrative Pilot	Major John C. Hall, USAF

MISSION JOINT TASK FORCE THREE

- I. TO PREPARE FOR AND CONDUCT TEST OF THREE EXPERIMENTAL ATOMIC WEAPONS

2. TO PREPARE FOR AND CONDUCT THE EXPERIMENTAL MEASUREMENTS PROPOSED BY THE ATOMIC ENERGY COMMISSION AND SO MUCH OF THE EXPERIMENTAL PROGRAMS PROPOSED BY THE ARMY, THE NAVY AND THE AIR FORCE (AND OTHER INTERESTED AGENCIES) AS MAY SUBSEQUENTLY BE APPROVED BY THE JOINT CHIEFS OF STAFF.

3. ON ASSUMPTION OF OVERALL MILITARY RESPONSIBILITY FOR ENIWETOK ATOLL, PROVIDE FOR LOCAL SECURITY OF THE ENIWETOK AREA.

CONTENTS

Key Personnel, Headquarters, Joint Task Force THREE
Personnel, J-Divisions
Ltr., Department of the Air Force, Subject: Armed
Forces Participation in 1951 Atomic Weapons Proof-Testing

Section I Organization & Mission

Mission, Joint Task Force THREE
Organization, Joint Task Force THREE
Mission, Task Group 3.1
Organization, Task Group 3.1
Mission, Task Group 3.2
Organization, Task Group 3.2
Mission, Task Group 3.3
Organization, Task Group 3.3
Mission, Task Group 3.4
Organization, Task Group 3.4

Section II Comptroller

GREENHOUSE Funds Program, FY 1950 - 1951
Overall Status of Funds FY 1951
Estimated and Actual Costs
Cumulative Costs, Joint Task Force THREE

Section III Operations

Situation Map, Atoll Area
Experimental Programs, Operation GREENHOUSE
Weather Stations, Atoll Area
Employment of Aircraft by Project
Projected & Actual Strength by Task Group
Projected & Actual Strength by Location
Water Shipments and Airlift Data
Soviet Reconnaissance Capabilities Against Eniwetok
Native Population Chart

Section IV Illustrations

GREENHOUSE Program
Alternate Program - Personnel
Alternate Program - Logistics
Aircraft Instrumentation Charts
Shot Island Instrumentation Charts
Air Situation Illustration
Screening & Integration of Experimental Programs Chart
Program and Test Structure Illustrations



JOINT TASK FORCE THREE STATISTICS

E. R. QUESADA

**LIEUTENANT GENERAL USAF
COMMANDER**

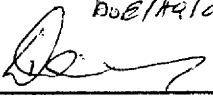
STATUS VERIFIED UNCLASSIFIED	
<i>Dis E/14/00 Appr 4-11/196</i>	
	<i>2/12/97</i>
AUTHORIZED DERIVATIVE	DATE
CLASSIFIER <i>Declassified</i>	

DECLASSIFIED

Authority MR 81-456 #1
By bc NLE Date 10/30/81

Prepared by:
Office, Statistical Services, JTF-3

