

DELETED VERSION ONLY

OPERATION REDWING

A PRELIMINARY REPORT

OF

 (BLACKFOOT)

Submitted by Task Group 7.1

RG 326 US ATOMIC ENERGY
COMMISSION

Location LANL

Collection S Div.

Folder Prelim. Rpt (Black-
foot) RSP-90 7/25/56

5684JFE

25 July 1956

BEST COPY AVAILABLE

CLASSIFICATION CANCELLED
WITH DELETIONS
BY AUTHORITY OF DOE/OC

J. Diaz 12/19/83
REVIEWED BY *Carl Wilson* DATE 12/16/85

37

Blackfoot

Project 10.1, pages 24 & 25 issued as a separate report (JC-240)

Distribution:

Copies 1&2A - Hoerlin

RG 326 US ATOMIC ENERGY
COMMISSION

Location LANL

Collection J-DIV

Folder Prelim. Rpt. (Black-
foot) ROP-96 7/25/56

COPIED/DOE
LANL RC

Blackfoot

Project 10.2, page 26 issued as a separate report (JO-241)

Distribution:

Copies 1&2A - Hoerlin

COPIED/DOE
LANL RC

2



CONTENTS

	<u>PAGE NO</u>
INTRODUCTION	4
PART I - GENERAL INFORMATION	5
Observed Weather at Shot Time	6
Fig. 0-1 - Eniwetok Atoll Map	9
Fig. 0-2 - Runit Island Map with Scientific Stations.	10
Fig. 0-3 - RadSafe Survey, D-Day.	11
PART II - DOD PROGRAMS	12
Project 1.9 - Water Wave Studies.	13
Project 2.51 - Neutron Flux Measurements and Shielding Studies	14
Project 6.1 - Accurate Location of Electromagnetic Pulse Source.	15
Project 6.3 - Effects of Atomic Explosions on the Ionosphere.	17
Project 6.4 - Determination of Characteristics of Airborne Flush Mounted Antennas and Photo Tubes for Yield Determination at Extended Ground-to-Air Ranges.	18
Project 6.5 - Analysis of Electromagnetic Pulse Produced by Nuclear Explosion	20
Project 6.6 - Electromagnetic Attenuation Measurements.	22
PART III - LASL PROGRAMS	23
Project 10.1 - Fireball Hydrodynamics.	24
Project 10.2 - Time of Arrival	26
Project 11.1 - Radiochemical Analysis.	27
Project 11.2 - Sampling.	28
Project 12.1 - Threshold Detectors	30
Project 12.2 - Phonex.	34
Project 13.1 - Measurement of Alpha and Boost.	39

U

	<u>PAGE NO.</u>
Project 13.3 - ENS Monitoring.	55
Project 15.1 - EG&G Photography.	56
Project 15.2 - High Speed Photography - Early Fireball Growth. . .	60
Project 16.3 - Electromagnetic Measurements.	73
PART IV - SC PROGRAMS.	74
Project 31.1 - Microbarograph.	75
DISTRIBUTION	76

COPIES/DOE ?
1948 PC



INTRODUCTION

This is a preliminary report, and therefore, does not give either complete or final results of the work of the various projects. No information on the construction of the device is included, in order that the classification may be kept to Secret Restricted Data.



It was detonated as the Blackfoot Shot on a 200 foot tower on Runit Island, Eniwetok Atoll, at 0620:00.2, June 12, 1956.]

The results of the various experiments are given in the following pages.

COPIED/COE
LANL RC

60

[REDACTED]

PART I

GENERAL INFORMATION

Observed Weather at Shot Time

Fig. 0-1 - Eniwetok Atoll Map

Fig. 0-2 - Runit Island Map with Scientific Stations

Fig. 0-3 - RadSafe Survey, D-Day

COPIED/DOE
LANL RC

[REDACTED]
[REDACTED] (BLACKFOOT)

ENIWETOK OBSERVED WEATHER FOR 12 JUNE 1956

AT DETONATION TIME 0626M

Sea Level Pressure	1012.5 mb
Free Air Surface Temperature	81.1°F
Wet Bulb Temperature	77.2°F
Dew Point Temperature	75.8°F
Relative Humidity	84.0%
Surface Wind	075° 10-14 knots
Visibility	10 miles

Clouds

2/10 cumulus; estimated at 1500 ft. Large cumulus with shower activity located $7\frac{1}{2}$ miles bearing 060° from Eniwetok. Top of this cumulus measured by radar at 37,000 ft.

1/10 stratocumulus; base estimated at 4500 ft.

2/10 or more altocumulus; estimated at 9000 ft. (opaque)

8/10 cirrostratus; estimated at 30,000 ft. (thin) (4/10 transparent)

Area Weather Summary From Aircraft Reports

3/8-5/8 cumulus over Eniwetok area with bases at 1500 feet and tops generally at 5000-7000 feet. Cumulonimbus located south of GZ with top at 35,000 feet. Some cumulonimbus tops estimated at 45,000 feet to north-east and north of GZ (no distance estimated). A scattered line of cumulonimbus about 30 miles east of GZ with tops estimated at 40,000 feet.

8/10 altostratus; bases at 13,500 ft with tops at 15,000 feet.

8/10-9/10 cirrostratus (very thin); based at 30,000 feet which appeared to be "breaking up" and dissipating.

Rain showers were observed to the east and west of GZ, no distances estimated.

COPIED/DOE 3
LANE RG 7

8

State of Sea

Ocean Side: Wave heights 5 feet, period 6 seconds, direction 090°.

Lagoon Side: Wave heights less than 1 foot.

ENIWETOK UPPER AIR SOUNDING (111715Z)

<u>Pressure</u> <u>(Millibars)</u>	<u>Height</u> <u>(Feet)</u>	<u>Temperature</u> <u>(°C)</u>	<u>Dew Point</u> <u>(°C)</u>
1004	-	26.4	23.7
1000	364	26.3	23.6
850	5,016	17.7	13.3
748	8,530	11.0	05.4
700	10,380	09.0	01.0
684	10,991	08.3	-00.9
600	14,521	00.9	-08.3
572	15,748	-01.9	-11.1
506	18,963	-06.4	-15.4
500	19,258	-07.0	-16.2
446	22,146	-12.5	-24.2
424	23,425	-16.0	-28.5
400	24,856	-18.5	-30.5
300	31,680	-34.0	-44.5
298	31,791	-34.6	-45.1
247	36,089	-43.2	M
200	40,604	-55.0	M
165	44,587	-66.0	M
150	46,411	-71.0	M
138	M	-75.0	M
109	52,461	-81.8	M
103	53,445	-78.7	M
100	54,029	-78.8	M
90	56,069	-78.0	M
60	63,858	-64.1	M
50	67,513	-65.2	M
47	68,570	-65.8	M
41	71,496	-61.4	M

CORRECTION
LANE RG

9

~~SECRET~~

WINDS ALOFT (Release Time 111715Z)

<u>Height</u> <u>(Feet)</u>	<u>Direction</u> <u>(Degrees)</u>	<u>Speed</u> <u>(Knots)</u>	<u>Height</u> <u>(Feet)</u>	<u>Direction</u> <u>(Degrees)</u>	<u>Speed</u> <u>(Knots)</u>
1,000	090	12	28,000	060	10
2,000	090	13	30,000	050	07
3,000	100	21	32,000	330	04
4,000	100	16	34,000	290	06
5,000	100	13	35,000	280	12
6,000	100	11	36,000	250	16
7,000	100	10	38,000	250	39
8,000	100	10	40,000	240	30
9,000	090	08	42,500	240	26
10,000	070	08	45,000	240	20
12,000	080	08	47,500	270	19
14,000	090	07	50,000	310	19
16,000	090	08	52,500	010	12
18,000	070	14	55,000	090	17
20,000	070	08	57,500	100	27
22,000	050	06	60,000	120	23
24,000	080	08	65,000	060	15
25,000	090	08	70,000	090	31
26,000	090	10	71,000	090	31

COPIED/DJE
LANE PC

550

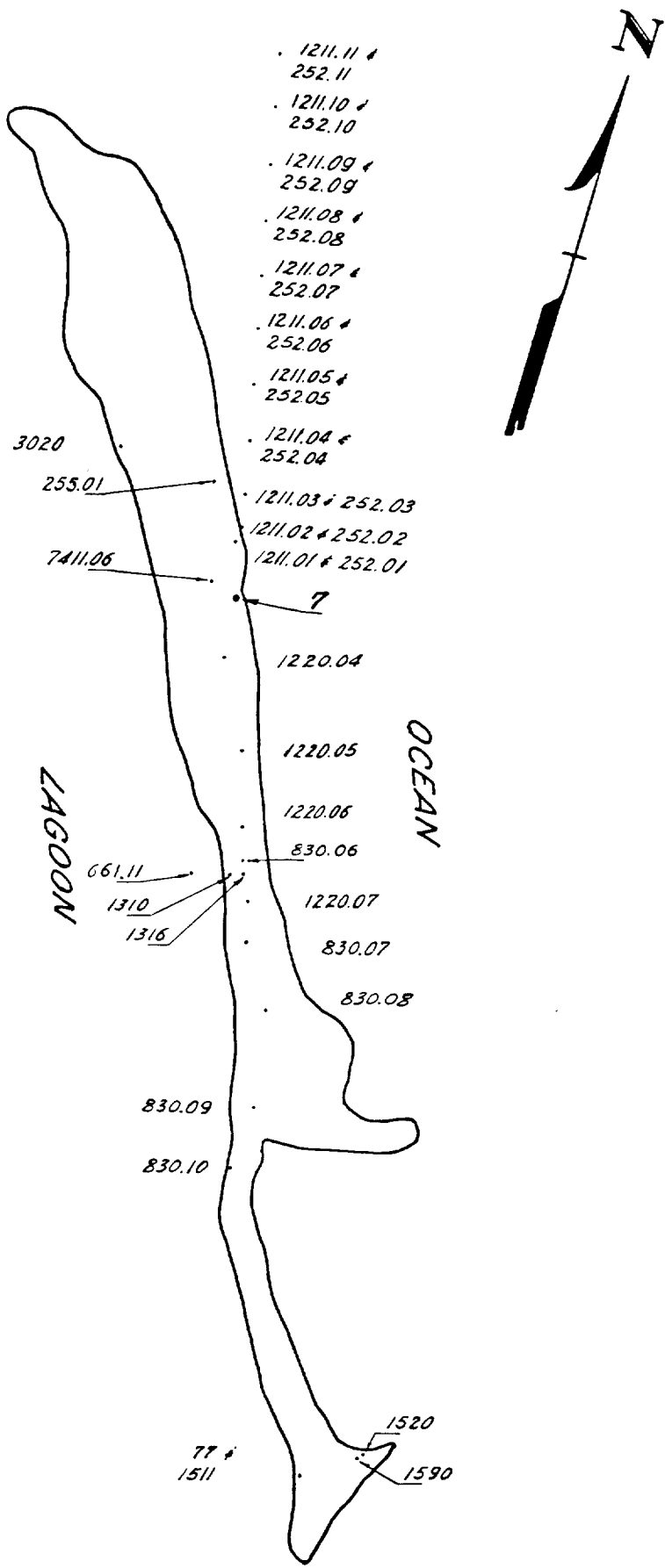

Fig. O-2 - Runit Island Map with Scientific Stations

CGFIEC/NOE
LANL RC

12

PART II

TASK UNIT 3

DOD PROGRAMS

K. D. Coleman
Col. K. D. Coleman
CTU-3

Program 1 - Elast and Shock Measurements	Maj. H. T. Bingham
Program 2 - Nuclear Radiation and Effects	CDR D. C. Campbell
Program 6 - Tests of Service Equipment and Materials	Lt Col C. W. Bankes

COPIED/DOE
LANL RC

[REDACTED]
[REDACTED] (BLACKFOOT)

Project 1.9 - Water Wave Studies - L. W. Kidd

OBJECTIVES AND INSTRUMENTATION

Studies of water wave action generated by the detonation of large yield (greater than 1 MT) nuclear devices are made at relatively close ranges and at several distant island stations by Project 1.9. Four shore recording wave measuring stations (of the Mark VIII type) were active in Bikini Lagoon for [REDACTED] (Blackfoot). In addition, Project 1.9 constructed and installed four new type long period wave recorders on Eniwetok, Ailinginae, Wake, and Johnston Islands. These recorders are designed to document long period, low amplitude deep ocean waves of the tsunami type. The recorders operate continuously but only receive significant signals from the large shots at Bikini. In addition to the above instrumentation, a tide gage was active at Ailinginae Atoll, and Sandia Corporation microbarographic stations were operated by Project 1.9 at Wake and Johnston.

RESULTS

The water wave stations were operating for this shot, but significant wave action was not observed.

COPIED/DOE
LANL RC

SECRET

(BLACKFOOT)

Project 2.51 - Neutron Flux Measurements and Shielding Studies -

C. W. Luke

OBJECTIVE

To measure the neutron flux as a function of distance from the point of detonation of a low yield high neutron flux device. Also to establish the nonvariance of the neutron-energy spectrum with increasing distance from the point of detonation.

To measure the relative attenuation of neutrons and gamma rays by various mixtures of concrete, borax, and sulfur.

RESULTS

As of this date no results are available. Lengthy counting procedures will prevent submission of definitive data until the Preliminary report is published.

SECRET/DUE
LANL RC

116

[REDACTED]
[REDACTED] (BLACKFOOT)

Project 6.1 - Accurate Location of Electromagnetic Pulse Source -

E. A. Lewis

OBJECTIVE

To utilize the electromagnetic signal originating from nuclear weapon detonations to determine ground zero of detonation. Secondly to obtain the yield data that is available in the bomb pulse.

PROCEDURE

Location of Ground Zero is made by use of an inverse Loran principle. The exact time the bomb pulse is received at various stations is recorded. The exact time difference in receipt of the electromagnetic pulse between two stations will be used to determine a hyperbolic curve which runs through ground zero. The point of intersection of two or more curves determines ground zero.

There are two systems. One of the systems is known as the long base line system and the other, the short base line system. Each system has two sets of stations. The long base line has one set of stations located in the Hawaiian Islands (Midway, Palmyra and Maui) with synchronizing antenna station at Haiku, Maui, and the other set of stations in the States (Harlingen, Texas; Elytheville, Arkansas; Kinross, Michigan and Rome, New York) with synchronizing antenna station at Cape Fear, North Carolina. The short base lines have one set of stations located in the Hawaiian area (Kona, Hawaii; Papa, Hawaii; and Red Hill, Maui) the other set in California (Pittsburg, Woodland, and Maryville).

17

[REDACTED]

RESULTS

Short Base Line

Hawaii - All stations in the Kona net received and recorded electromagnetic pulse emanating from bomb detonation. Line positioning error was 6 nautical miles. Maximum field strength was 0.3 volts per meter.

California - All stations in the Woodland net received and recorded the electromagnetic pulse emanating from the bomb detonation. Line of positioning error was 4 nautical miles. Maximum field strength was .3 volts per meter.

Long Base Line

Hawaii - All stations in the Lahaina net received and recorded the electromagnetic pulse emanating from bomb detonation. The fix error was 480 yards.

Stateside - All stations in the Harlingen net received and recorded the electromagnetic pulse emanating from the bomb detonation.

Griffiss AFB equipment operated satisfactorily.

The above line of position errors may change considerably during further examination of the data.

[REDACTED]
[REDACTED] (BLACKFOOT)

Project 6.3 - Effects of Atomic Explosions on the Ionosphere - M. Hawn

OBJECTIVE

The objective of Project 6.3 is to obtain data on the effects of high yield nuclear explosions on the Ionosphere. Principally, to investigate the area of absorption, probably due to the high altitude radioactive particles, and to study the effect of orientation relative to the earth's magnetic field on F2 layer effects.

INSTRUMENTATION

The system comprises:

Two Ionosphere recorders, type C-2, operating on pulse transmission, installed in 6 ton trailer vans, one located at Rongerik Atoll and one located at Kusaie in the Caroline Islands.

One Ionosphere recorder, type C-3, operating on pulse transmission, installed in a C-97 plane based at Eniwetok Island.

RESULTS

All stations operated successfully during this test. Ground records were taken by the C-97 as it was grounded at Kwajalein while a new engine was being installed.

There were no noticeable effects on the ionosphere from this test.

COPIED/DOE
LANL RC

19

[REDACTED]

[REDACTED] (BLACKFOOT)

Project 6.4 - Determination of Characteristics of Airborne Flush Mounted
Antennas and Photo Tubes for Yield Determination at
Extended Ground-to-Air Ranges - A. J. Waters

OBJECTIVES

To determine the effectiveness of flush mounted airborne antennas and phototubes at various ground-to-air ranges in detecting characteristic low frequency electromagnetic radiation and visible radiation, respectively.

To determine the temporal and amplitude characteristics of the low frequency electromagnetic radiation at various ground-to-air ranges.

To determine the temporal and intensity characteristics of visible radiation at various ground-to-air ranges.

To determine the effects of ambient conditions upon the satisfactory measurement of the parameters specified in items 1 and 2 above.

INSTRUMENTATION

- 2 fiducial antennas
- 1 scope camera
- 1 synchronizer
- 1 DuMont Scope (dual beam)

TECHNIQUE

Signal is received by antenna fed through an amplifier and then to the scope. The signal is then photographed. Photohead output is let directly to the recorder. The sequence camera photographs the blast directly for use in correlation of previous data. Distance was approximately 10 miles.

RESULTS

Equipment was removed from plane and set up at Parry Island on

COPIED/DOE
LANL RC

~~SECRET~~

the ground. Because of limited time available to remove equipment from the airplane and put it aboard transport plane, only certain portions were taken.

Equipment was set up, checked and was in operating condition. Signal was received by each antenna and seen on the scope. However, due to camera difficulty, the picture did not come out.

Project 6.5 - Analysis of Electromagnetic Pulse Produced by Nuclear
Explosion - C. J. Ong

OBJECTIVE

The objective of Project 6.5 is to obtain waveforms of the electromagnetic radiation for all the detonations during Operation REDWING. This data is to be used in connection with a continuing study relating the waveform parameters to the height and yield of the detonation.

INSTRUMENTATION

Two identical stations are used to record data, one at Eniwetok and one at Kwajalein.

The instrumentation consists of a wide-band receiver with separate outputs connected to each of the three oscilloscopes. Mounted on each oscilloscope is a Polaroid Land Camera for recording the transient display.

The wide-band receiver consists of one primary and four secondary cathode follower amplifiers. An antenna, frequency insensitive in the range of interest is fed directly into the primary cathode follower. The primary cathode follower is then connected to four individual cathode followers by a 50-ohm coaxial cable. Only three secondary cathode followers are utilized, the fourth serving as a spare.

The number one and two cathode followers feed oscilloscopes with sweep speeds of approximately 30 microseconds per centimeter and 10 microseconds/centimeter respectively. The number three cathode follower is connected to the third oscilloscope through a 2 microsecond delay line. The third oscilloscope has a sweep speed of 1.0 microseconds/centimeter. All oscilloscopes were triggered simultaneously by the

COPIED/DOE
LANL RC

27

DC trigger device located in the primary cathode follower and connected directly to the receiving antenna. The 2 microsecond delay line was added to permit the leading edge of the waveform to be recorded.

In order to establish a definite time relationship between the reception of the signal and the triggering of a given device such as a counter or transmitter, a time marker pip, generated by the delay trigger from one of the oscilloscopes, is fed through the 2 microsecond delay line and superimposed on the initial portion of the received waveform.

PROCEDURE

All oscilloscopes are calibrated against a known frequency standard for sweep linearity.

The cathode follower triggering system is set to trigger approximately 6db. above the noise level. The vertical deflector of the oscilloscopes are set to receive the predicted field strength.

RESULTS

Station A - Farry Island

No data obtained for this shot since oscilloscopes had already been triggered by signal from FLATHEAD.

Station B - Kwajalein

Since there are two traces present in the photo it is assumed that both FLATHEAD and BLACKFOOT traces are present. Since the oscilloscope sensitivities had been set for FLATHEAD, the trace of BLACKFOOT is of such a small amplitude that it is of questionable value. One scope did not trigger.

COPIED/DOE
LANL RC

23

[REDACTED]
[REDACTED] (BLACKFOOT)

Project 6.6 - Electromagnetic Attenuation Measurements - T.D. Hanscome

OBJECTIVE

To make electromagnetic attenuation measurements as a function of time at S-band (2160 MC) and X-band (9400 MC).

PROCEDURE

Equipment used at this shot consisted of a transmitter installed at approximately 5000' from the tower on a line to the receiver in a tower on Parry. The receiver output was delayed 2 microseconds and displayed on oscilloscopes having sweep speed of 5 microseconds per centimeter, 50 microseconds per centimeter, 200 microseconds per centimeter and on a Brush recorder (resolving time 10 milliseconds).

Sweeps were triggered by "blue box" signals. One receiving antenna was aimed at the shot tower to observe direct electromagnetic effect. The receiver scope on this system was swept at 5 microseconds per centimeter.

RESULTS

Electromagnetic Effect

The channel directed to this effect operated. No direct electromagnetic effect was observed during the first 50 microseconds. The upper limit of electromagnetic effect is about 115 db below 1 watt at the receiver input (9375 MC, 40 db antenna gain, 10 MC band width).

9450 MC Transmission Path

The channel devoted to attenuation at 9450 MC operated successfully. Preliminary indications are that the attenuation at this distance (calculated for 10^9 electrons per cc produced by prompt gamma rays) is in the order of 15 db. The recovery was fast and the signal level was adequate for telemetering use after approximately 10 microseconds.

PART III

TASK UNIT 1

LASL PROGRAMS

Keith Boyer
Keith Boyer
Advisory Group

Program 10 - Thermal Radiation and Hydrodynamics	H. Hoerlin
Program 11 - Radiochemistry	G. Cowan
Program 12 - External Neutron Measurement and High Energy Gamma Measurement	R. L. Aamodt
Program 13 - Fission Reaction Measurements	J. S. Malik
Program 15 - Photo-Physics	G. L. Felt
Program 16 - Physics & Electronics & Reaction History	B. E. Watt

COPIED/DOE
LANL RC

[REDACTED]

[REDACTED] (BLACKFOOT)

Project 10.1 Fireball Hydrodynamics - J. F. Mullaney

L. N. Blumberg & J. F. Mullaney

COPIED/DOE
LANL RG

[REDACTED]

26

23



Lou Gatt of Group T-1 assisted in the reduction of data and
computation of results



COPIED/DOE
LEAD 105



27

[REDACTED]

[REDACTED] (BLACKFOOT)

Project 10.2 - Time of Arrival - J. F. Mullaney

L. N. Blumberg

Atmospheric conditions of interest, provided by Weather Central (ENIWETOK) at shot time, are:

- Pressure: 1012.5 mb
- Temperature: 81.0°F
- Wind: 14 Knots from 070°
- Dew Point: 75.0°F

From these data, a sound speed of 1146.0 fps was calculated. The results of the time-of-arrival calculation are presented in Table 10.2-1.

TABLE 10.2-1

<u>STATION</u>	<u>RANGE (ft)</u>	<u>BEARING</u>	<u>RANGE, WIND-CORRECTED (ft)</u>	<u>TIME INTERVAL (Seconds)</u>	<u>YIELD (KT)</u>
Sta. 71, Parry	51,179	172° 01'	50,967.8	[REDACTED]	[REDACTED]

COPIES MADE FROM ORIGINAL

[REDACTED]

28

[REDACTED]
[REDACTED] BLACKFOOT)

Project 11.1 - Radiochemical Analysis - G. Cowan

COPIED/DOE
LANL RC

29

[REDACTED]

[REDACTED] (BLACKFOOT)

Project 11.2 - Sampling - H. F. Plank

P. F. Moore

EQUIPMENT

Seven aircraft equipped for cloud sampling as described in the [REDACTED] Report were used on this mission: "A" flight, Tiger White I (F-84); "B" flight, Tiger White II (F-84); "C" flight, Tiger Blue I and II (2-F-84's); "D" flight, Tiger Yellow I and II (2-F-84's); and Cassidy II (B-57) the control aircraft.

WEATHER

The wind pattern was in general suitable for sampling, with winds blowing from the East at velocities up to 17 knots at expected sampling altitudes but with very little change in direction or velocity, i.e., a favorable wind shear. As zero time approached, Cassidy II observed a large cumulus cloud structure running up to about 32,000 feet sitting over ground zero, which could have completely obscured the bomb cloud for sampling purposes. The 10 minute delay in shot time allowed a big hole in the cloud system to move over ground zero and the bomb cloud went into this hole and remained visible throughout the sampling operation.

CLOUD DESCRIPTION

The bomb cloud rose in an anvil headed column to about 32,000 feet (10,000 feet higher than the prediction) and spread out into the hole in the natural cloud structure. The top of the bomb cloud penetrated into a solid overcast at 31,000 feet and the bottom of the bomb cloud emerged from the top of another overcast at 15,000 feet. Big cumulus columns were ranked about, joining the undercast and the overcast and forming a larged closed amphitheatre within which aircraft could fly and still easily see the bomb cloud standing in the middle.

COPIED/DOE
LANL RC

30

[REDACTED]

By sampling time, the bomb cloud had separated into three major portions: the top portion rubbing up against the bottom of the overcast at 30,000 feet, a middle portion centered at 25,000 feet and the lower portion appearing to the eye like red dirt shoveled over the top of the undercast at 15,000 feet. All portions of the bomb cloud maintained a strong reddish brown color and although semi-transparent in appearance, were always readily visible; particularly with the aid of brown sunglasses or helmet visors.

SAMPLING MISSION

Because of the apparent thinness of the cloud, Tiger White I was directed in at 30,000 feet and plus 50 minutes for a brief sniff and reported radiation intensity averaging 40 roentgens per hour. About this time, the landing field was closed by heavy rain so White I was held off for 23 minutes before being put into the same portion for his sampling run. Cloud intensities had dropped by a factor of 4 to 5 in this comparatively brief time. Tiger White II was put in at 25,000 feet and plus 98 minutes and found radiation intensities about the same. Blue I and II were directed into the visible bottom of the cloud spread along the undercast at 15,000 feet and collected a required sample with no difficulty, even though the activity encountered was in spots and patches. Yellow I and II were directed into the middle portion of the cloud at 2 hours after burst and encountered radiation intensities averaging from 4 to 5 roentgens per hour, about as expected for that time.

NUMBER RATIOS

The number of fissions measured in the samples by Radio-Chemistry at Los Alamos averaged about 77% of the number predicted at PPG from observation of radiation levels of sample papers as removed from the aircraft. The discrepancy was more than compensated for, by the pre-planned increase in pilots dosage based on experience from preceding REDWING shots.

COPIED/DOE
LAWL RG

[REDACTED]
[REDACTED] (BLACKFOOT)

Project 12.1 - Threshold Detectors - W. A. Biggers

R. L. Aamodt

DELETED

32

COPIED
1/12/50



33

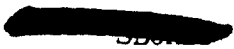

TABLE 12.1-1

Transmission Calculations

[REDACTED]

1



COPIED/DOE
LANL RG

COPIED/DOE



25

[REDACTED]
[REDACTED] (BLACKFOOT)

Project 12.2 - Phonex - D. Phillips

The same type of concrete and paraffin shield was already constructed for BLACKFOOT as had been designed for [REDACTED] (ERIE). The necessary modifications were also similar except that there was a little more time available. One of the three phonex stations for [REDACTED] (BLACKFOOT) was eliminated (600 yds.), leaving the 300 yd. and 450 yd. stations. The line of sight to the 300 yd. station was through a 3" I. D. transite pipe with $\frac{1}{2}$ " wall. This pipe was removed from the concrete and paraffin shield. The only thick wall heavy material tubing available was a piece of stainless steel 2" I. D. with $\frac{3}{4}$ " wall. This was wrapped with $\frac{1}{8}$ " lead sheet, leaving approximately $\frac{1}{8}$ " clearance between the lead and concrete or paraffin. This space was filled, after careful alignment, with a thin concrete grout. The plywood liner of the rectangular aperture was also removed and the same type of $\frac{3}{4}$ " wall stainless steel tube wrapped with $\frac{1}{8}$ " lead was carefully fixed in position. A thinner walled tube was placed along the J-13 line of sight through the shield. The space around these pipes was then filled with concrete grout.

No particular precautions were taken with the 450 yd. station except that it was extensively sand bagged. Every effort was made to reduce the blackening of the G2 emulsions at the 300 yd. station. Four inches of lead shielding was constructed on top, front and both sides of the collimator block. This was built from 1100 lead bricks with lead wool chinking.

The front blast plate had three $1\frac{1}{4}$ " I. D. tubes 6" long welded

COPIED/DOE
LANL RC

36

[REDACTED]

perpendicular to the plate. The lines of sight of the three collimator tubes passed through these three extensions. Thirty-two pieces of 1/8" lead sheet were cut so as to fit over the front blast plate, leaving three holes for the lines of sight. The line of sight was of course not entirely clear, having to pass through the 3/8" steel blast plate as well as 3/4" of B¹⁰.

An old phonex collimator block which had broken into three pieces was used for additional shielding. One section was placed on edge along each side of the station and the third section was placed across the top of the collimator. This section was rotated through 90° so that it was flush with the front of the station but projected about 10" over each side. The whole station was then covered with sand bags.

In addition to extra shielding, two bar magnets were fastened one on each side of the radiator so that the magnetic field between them was perpendicular to the axis of the camera. It was hoped by this method to reduce blackening of the plates by Compton electrons. This method had been shown to reduce blackening of emulsions in phonex cameras at the Nevada Test Site. All cameras at the 300 yd. station were equipped with these magnets. Furthermore, a two inch lead plug was placed in the 1½" pipe in front of the top collimator tube, so as to reduce the gamma ray flux down the collimator tube.

Recovery was made by Allen, Frye and two H & N men (Brennan and Kaneshiro) late in the afternoon of B-day. Helicopter recovery had been used after had been used after [REDACTED] (ERIE), but after [REDACTED] (BLACKFOOT) a 6 x 6 truck was landed from a T-boat. The truck carried a heavy recovery box with 3" of lead shielding all around it, and space inside for six phonex cameras. Recovery from the 300 yd. station was

COPIED/DOE
LANL RQ ✓

[REDACTED]

made first, where the radiation field was 10 r/hr. The cameras were placed in the lead box and the truck driven to the 450 yd. station where the radiation field was only 1 r/hr. and the cameras from this station were then recovered.

The following day, development of the plates from two of the cameras at the 300 yd. station and from one of the cameras at the 450 yd. station were started.

Each of the [REDACTED] (BLACKFOOT) cameras contained four plates with C2 emulsions, all at rear positions. Two plates with E1 emulsions were placed at forward raised positions.

The C2 emulsions from the 300 yd. station look to be readable. They cannot be analysed on the microscope that we have here (Parry Island). There is no water cell to cool the illuminating beam. The heat from the intense light beam required pits the emulsion.

Four hundred and eighteen tracks were measured on one of the C2 plates from the 450 yd. station by Glen Frye. The results of this analysis are shown in Table 12.2-1 and the neutron energy spectrum extrapolated back to the outside of the bomb is shown in Fig. 12.2-1.

It should be emphasized that these data are preliminary. Attention is called to the number of tracks recorded for each half mev energy interval as shown in the table.

We wish to thank J. Hill, R. Newman and R. Blossom for their assistance in making last minute changes. Also we would like to state our appreciation of the cooperation which we have received from Buddy Schutz and the other machinists.

COPIED/DOE
LANL RG

[REDACTED]
[REDACTED] (BLACKFOOT)

TABLE 12.2-1

PLATE #14BB

DELETED

COPIED/DOE
LANL RC

7-0

[REDACTED]
[REDACTED]
(BLACKFOOT)

Project 13.1 - Measurement of Alpha and Boost - H. Grier

J. Malik

DELETED

COPIED/DOE
LAME RG ✓

41

[REDACTED]

[REDACTED]

CHIEF/DOE
15 BB ✓

[REDACTED]

4

[REDACTED] (BLACKFOOT) SUMMARY SHEET

DELETED

(BLACKFOOT) SUMMARY SHEET

COPIED/DOE
LANL RC

44

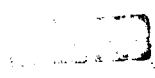

LEVEL RR
LW/DGE

4
CORPORATE
LANDS

[Handwritten mark]

[Handwritten mark]

[Handwritten mark]

4/20/2020
RECEIVED
4/20/2020

[Redacted text]

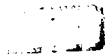

COPIED/DOE
LANL RC

47





GEORGE W. BUE
LAWL RD

48





COPIED/DOE
LANL RC

49



COPIED/DOE
LANL RC

50



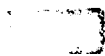

COPIED/DOE
LANL RC

51

49

CC
1/2
T

COPIED/DOE
LANL RC

COPIED/DOE
LANL RC



113

COPIED/DOE
LANL RC

54





COPIED/DOE
LANL RC

CU
LA

55



1110

COPIED/DOE
LANL RC

CL
L

56

COPIED/DOE

[REDACTED]
SECRET

[REDACTED]
(BLACKFOOT)

Project 13.3 - ENS Monitoring - D. Henry

J. Malik

Monitoring of the S-units used to detonate the device was performed by Sandia (Mc Campbell) using their microwave telemetering system.

DELETED

[REDACTED]



(BLACKFOOT)

Project 15.1 - EG&G Photography, Fireball and Ehangmeter - H. Grier

D. J. Barnes

FIREBALL

Yields for [REDACTED] were computed from three films, one each from Parry, Piirai, and Mack.

DELETED

EHANGMETERS

Four Ehangmeters at the control point gave time-to-minimum readings

DELETED

[REDACTED]

58

To reproduce this page use JDO Log # RCE-3051, which is a Blackfoot fireball negative, together ~~ix~~ with a photo mat layout showing classification top and bottom, Figure # and page #. From this material Graphic Arts can make a composite neg and produce glossy prints.

①	NOTE: FILE BY JOB NO. & DATE
	JOB NO. <u>Blackfoot</u> DATE _____
FILM NOS. <u>35442</u> TO _____	
CAMERA NO. _____	
E. G. & G. BOOK NO. _____ PAGE _____	
NAME _____ BOOK NO. _____	
SUBJECT _____	
REMARKS: _____	
F.B. Page 57	
PGC-2396	
RCE-3051	
FORM DI 11-54 5M	

Fig. 15.1-1

To reproduce this page see instruction for page 57, using
JDO Log # RCE-3053, Blackfoot Fireball negative.

(2)

NOTE: FILE BY JOB NO. & DATE

JOB NO. Blackfoot DATE _____

FILM NOS. 3544 TO _____

CAMERA NO. _____

E. G. & G. BOOK NO. _____ PAGE _____

NAME _____ BOOK NO. _____

SUBJECT _____

REMARKS: _____

F.B.
PPG-2396 Page 58
RCE-3053

FORM DI 11-54 5M

Fig. 15.1-2

To reproduce this page see instructions for page 57, using
JDO Log # RCE-3052, Blackfoot Fireball Negative.

③	NOTE: FILE BY JOB NO. & DATE	
	JOB NO. <u>Blackfoot</u>	DATE _____
FILM NOS. <u>25440</u>	TO _____	
CAMERA NO. _____		
E. G. & G. BOOK NO. _____	PAGE _____	
NAME _____	BOOK NO. _____	
SUBJECT _____		
REMARKS:		
	F.B.	Page 59
	02996	
	ppg-1306	RCE-3052
		FORM DI 11-54 5M

Fig. 15.1-3

COVERED
LAME TO

61

[REDACTED]

[REDACTED]
BLACKFOOT

Project 15.2 - HIGH SPEED PHOTOGRAPHY - G. L. Felt

EARLY FIREBALL GROWTH

The observations to be made on the [REDACTED] using high speed photography, were fireball growth for the first 150 microseconds. The cameras used were two Model 100 streak cameras at 500 rps, two at 1,000 rps, two at 4,000 rps, and two framing cameras. The two fastest streak cameras and the framing camera with 16 shakes per frame used HPS film. All other cameras were loaded with the Eastman color film, and the color frame camera wrote at 30 shakes per frame. The black and white framing camera had the three sided model 8 mirror that gives 15 shakes per frame. All cameras had 80 inch lenses on them except for the two very slow streak cameras which used 40 inch lenses. Because of the elevation of the tower, the horizontal camera slits projected on the cab to an angle about two degrees from horizontal.

DELETED

[REDACTED]

62

[REDACTED]

SECRET

[REDACTED]

TABLE 15.2-1

DELETED

65
33

~~SECRET~~

To reproduce this page use Graphic Arts Neg. # F000-102

COPIED/DOE
LANL RC

~~SECRET~~

66



To reproduce this page use Graphic Arts Neg. F000-99

COPIED/DOE
LANL RC



67



To reproduce this page use Graphic Arts Neg. # F000-101

COPIED/DOE
LANL RC



68



To reproduce this page use Graphic Arts Neg. # F000-105

COPIED/DOE
LANL RC



To reproduce this page use Graphic Arts Neg. No. ~~KXXXXX~~ F000-97

COPIED/DOE
LANL RC



10
W

[REDACTED]

To reproduce this page use Graphic Arts Neg. No. F000-103

COPIED/DOE
LANL RC

[REDACTED]

71



To reproduce this page use Graphic Arts Neg. No. F000-104

COPIED/DOE
LANL RC



72

[REDACTED]

To reproduce this page use Graphic Arts Neg. No. F000-98

4

COPIED/DOE
LANL RC

[REDACTED]

70



To reproduce this page use Graphic Arts Neg. No. F000-100

COPIED/DOE
LANL RC



74

[REDACTED]
[REDACTED] (BLACKFOOT)

Project 16.3 - Electromagnetic Measurements - R. Partridge

DELETED

~~SECRET~~

PART IV

TASK UNIT 4

SC PROGRAMS

E L Jenkins

E. L. Jenkins
CTU-4

Program 31 - Microbarography

R. Heppelwhite

COPIED/DOE
LANE RC

~~SECRET~~

710

~~██████████~~
~~██████████~~ (BLACKFOOT)

Project 31.1 - Microbarograph - W. A. Gustafson

The purpose of this project was to measure winds in ozone layer of the atmosphere. This was accomplished by measuring at several sites the arrival times of the shock wave reflected from the ozone layer. Four sites were operated: Ujelang, Wotho, Rongerik, and Eniwetok. At each site two stations were operated about one mile apart. The difference in arrival times gives the angle of incidence of the shock and information from several stations may be combined to give the winds.

On ~~██████████~~ (BLACKFOOT) good shot records were obtained from all stations except Rongerik, which had high ambient wind noise. However enough directions are available for the Bikini shot to allow ozonosphere wind and temperature resolution, but this has not yet been accomplished.

~~_____~~

DISTRIBUTION:

Copy 1A - CJTF SEVEN (B. H. Hanlon)
2A - DCSM, JTF SEVEN (W. E. Ogle)
3A - CTG 7.1 (G. L. Felt)
4A - D/UCRL, TG 7.1 (G. W. Johnson)
5A - D/DOD, TG 7.1 (L. L. Woodward)
6-7A - DMA, USAEC (A. D. Starbird)
8-9A - Chief AFSWP (A. R. Ludecke)
10-14A - Report Library, LASL
15-19A - UCRL (H. York)
20-24A - Field Command, AFSWP (F. O'Beirne)
25-29A - Sandia Corp (R. A. Bice)
30A - ALOO, USAEC (J. E. Reeves)